



## LABURNUM PLACE, SE9

£300,000

Top floor apartment  
Fully refurbished  
Kitchen with AEG appliances  
Shower room with roca suite  
Garage in block  
Energy rating: D

@marshandparsons  
marshandparsons.co.uk

MARSH &  
PARSONS



# ABOUT THE PROPERTY

A beautifully refurbished top floor one bedroom apartment finished to a high standard and in excellent condition throughout. Features include a bright living area, modern kitchen with integrated AEG appliances, spacious bedroom with fitted wardrobes, and a stylish shower room with Roca suite and Italian tiling. Additional benefits: new windows, updated electrics and heating, ample storage, well-maintained communal gardens, and a garage. Share of freehold, long lease, and low service charge ideal for first time buyers or investors.

Well located for Eltham Park South, local amenities and Eltham station.



# STEP INSIDE LABURNUM PLACE

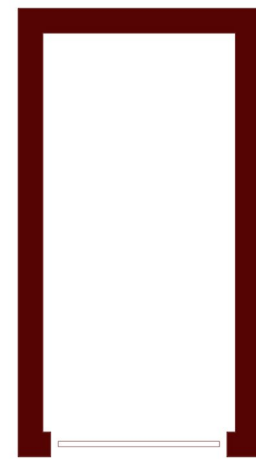
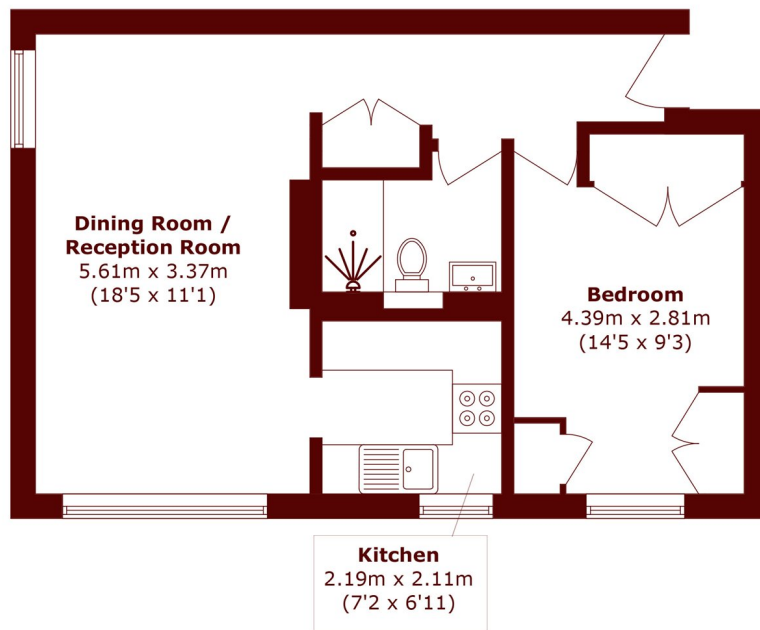

**Garage**

Total area (approx.): 47.3 sq. m (509.1 sq. ft)  
Garage area (approx.): 11.4 sq. m (122.7 sq. ft)

Lee  
020 8378 5450

Energy Rating: D We aim to make our particulars both accurate and reliable. However, they are not guaranteed; nor do they form part of an offer or contract. If you require clarification on any points then please contact us, especially if you're traveling some distance to view. Please note that appliances and heating systems have not been tested and therefore no warranties can be given as to their good working order

**MARSH &  
PARSONS**