



ELM GROVE, SW19

£2,100 per month

One bedroom
Contemporary design
Recent development
Open plan
Unfurnished
Energy rating: b

@marshandparsons
marshandparsons.co.uk

MARSH &
PARSONS



ABOUT THE PROPERTY

A recently built one bedroom first apartment available in the Watson Studios Development. This converted warehouse is located 0.5 miles from Wimbledon Station and comprises an open plan kitchen/reception room, double bedroom and bathroom. The property is finished to a high specification.



STEP INSIDE ELM GROVE

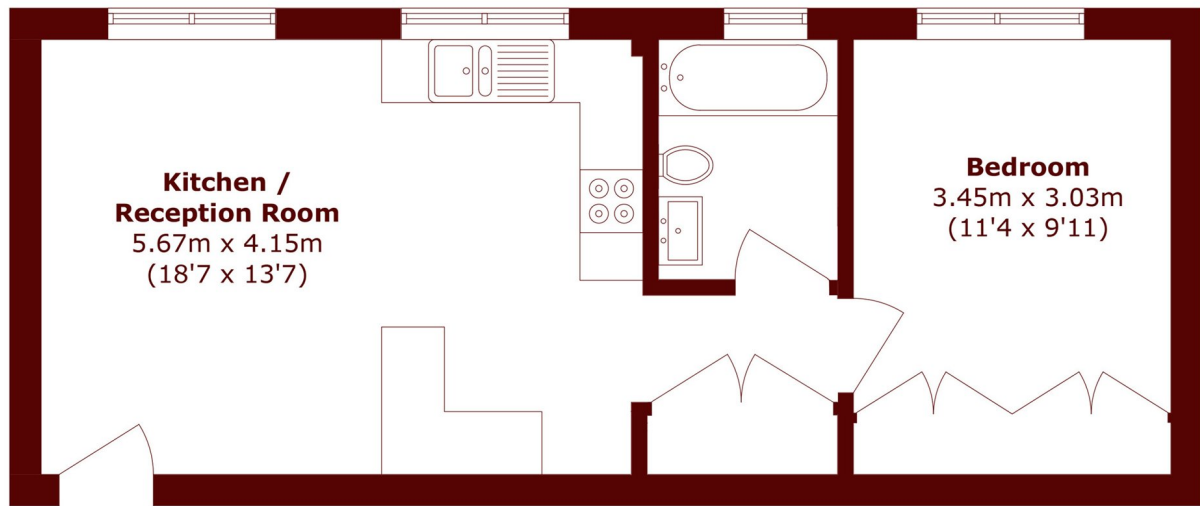

Total area (approx.): 44.7 sq. m (481.1 sq. ft)

Wimbledon
020 8879 6661

Energy Rating: B We aim to make our particulars both accurate and reliable. However, they are not guaranteed; nor do they form part of an offer or contract. If you require clarification on any points then please contact us, especially if you're traveling some distance to view. Please note that appliances and heating systems have not been tested and therefore no warranties can be given as to their good working order

MARSH &
PARSONS