



GEORGE HOUSE, NW6

£550,000

Situated on the sixth floor of a smart modern building, this large two-bedroom apartment is presented with incredibly stylish interiors and benefits from generous proportions and an abundance of natural light.

Two bedrooms
Balcony
High specification

Engineered Oak flooring
Fitted wardrobes
Green spaces

STEP INSIDE GEORGE HOUSE

George House, Albert Road, NW6

APPROX. GROSS INTERNAL FLOOR AREA 846 SQFT / 78.59 SQM

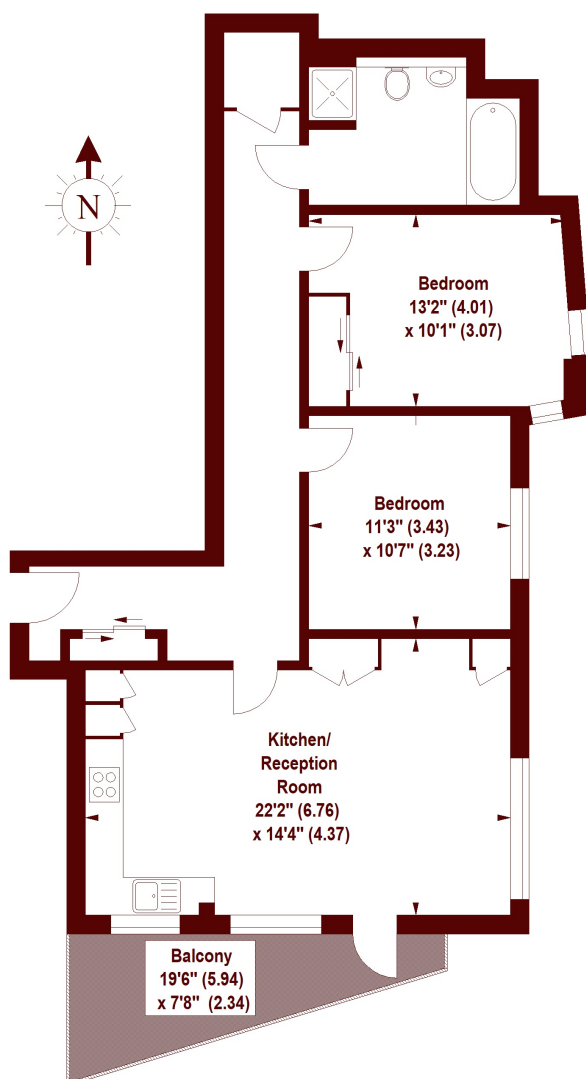

SIXTH FLOOR

The floor plan is not to scale and measurements and areas shown are approximate and therefore should be used for illustrative purposes only. The plan has been prepared in accordance with the RICS code of Measuring Practice and whilst we have confidence in the information produced, it must not be relied on.

If there is any aspect of particular importance, you should carry out or commission your own inspection of the property.

Copyright of FeaturePRO.

Little Venice
020 7993 3050

Energy Rating: B We aim to make our particulars both accurate and reliable. However, they are not guaranteed; nor do they form part of an offer or contract. If you require clarification on any points then please contact us, especially if you're traveling some distance to view. Please note that appliances and heating systems have not been tested and therefore no warranties can be given as to their good working order

MARSH &
PARSONS