



URLWIN WALK, SW9

£2,500 per month

Two bedrooms
Two bathrooms
Private garden
Recently refurbished
Eat-in kitchen
Close to transport

@marshandparsons
marshandparsons.co.uk

MARSH &
PARSONS



ABOUT THE PROPERTY

This well-presented two bedroom house offers well-balanced accommodation arranged over two floors. The property comprises a reception room with space to dine, a separate kitchen, two bedrooms and two bathrooms, making it ideal for professional tenants or a family.

Urlwin Walk is located in SW9, within easy reach of a range of local shops, cafés and restaurants. Transport links are available from nearby Stockwell and Brixton stations, providing convenient access across London.



STEP INSIDE URLWIN WALK

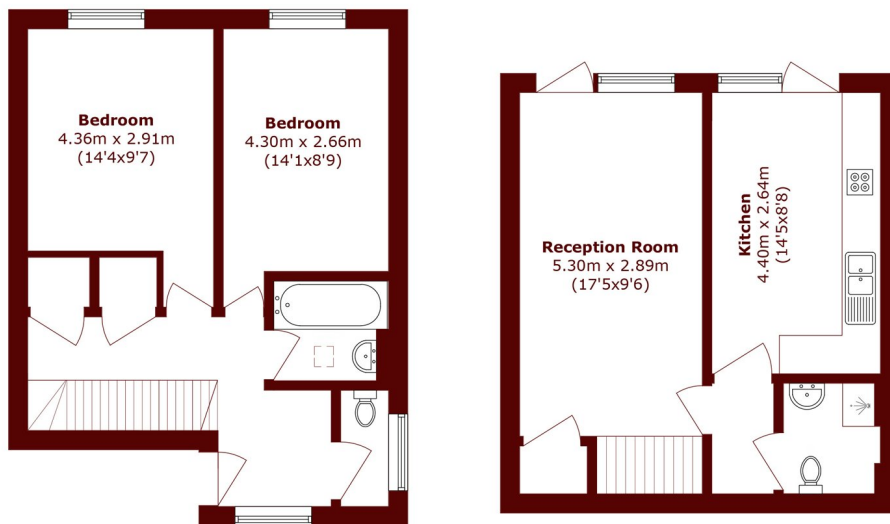

Total area (approx.): 74.2 sq. m (798.7 sq. ft)

Kennington
020 7932 2920

Energy Rating: D We aim to make our particulars both accurate and reliable. However, they are not guaranteed; nor do they form part of an offer or contract. If you require clarification on any points then please contact us, especially if you're traveling some distance to view. Please note that appliances and heating systems have not been tested and therefore no warranties can be given as to their good working order

**MARSH &
PARSONS**