



BOLLO LANE, W4

£340,000

Spacious one-bedroom
Pocket living scheme
New build development
Amazing views
Communal roof terrace
Energy rating: b

@marshandparsons
marshandparsons.co.uk

MARSH &
PARSONS



ABOUT THE PROPERTY

A spacious one-bedroom apartment within a new build development on Bollo Lane, Chiswick. The property offers amazing views, a roof terrace, and a modern specification throughout.

Perfectly located on Bollo Lane, the property is just a short stroll from Chiswick Park Underground Station (District Line) and South Acton Overground Station, offering fast connections across London. Residents will also enjoy Chiswick's vibrant high street, local cafés, and expansive green spaces all within easy reach.



STEP INSIDE BOLLO LANE

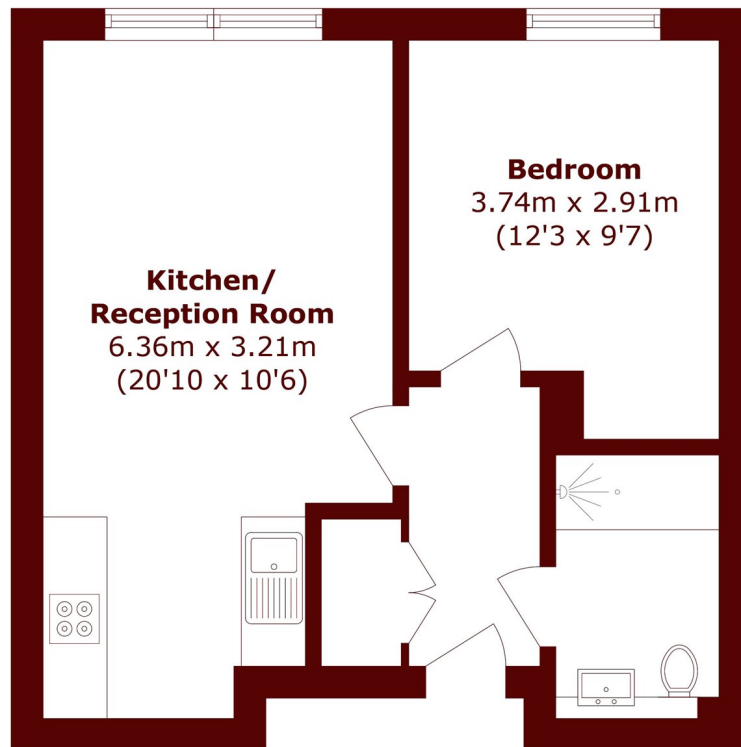

Total area (approx): 39.5 sq. m (425.1 sq. ft)

Chiswick
020 8994 2556

Energy Rating: B We aim to make our particulars both accurate and reliable. However, they are not guaranteed; nor do they form part of an offer or contract. If you require clarification on any points then please contact us, especially if you're traveling some distance to view. Please note that appliances and heating systems have not been tested and therefore no warranties can be given as to their good working order

MARSH &
PARSONS