



CARNEY PLACE, SW9

£350,000

One Double Bedroom
Open-Plan Living
Ground Floor
Beautifully Maintained
Secure Gated Development
Energy Rating: C

@marshandparsons
marshandparsons.co.uk

MARSH &
PARSONS

ABOUT THE PROPERTY

A spacious and beautifully maintained one bedroom apartment set on the ground floor spanning 523 sqft comprising of one double bedroom, a modern bathroom, a stylish kitchen offering ample storage with integrated appliances and a generous open plan dining-living area leading directly to a peaceful courtyard.

Carney Place is conveniently located in the heart of Brixton moments from the vast array of independent shops, cafes and restaurants including the popular Brixton Village with easy access to the excellent transport links of Brixton Underground Tube (Victoria Line) and Overground with direct links into central London.









STEP INSIDE CARNEY PLACE

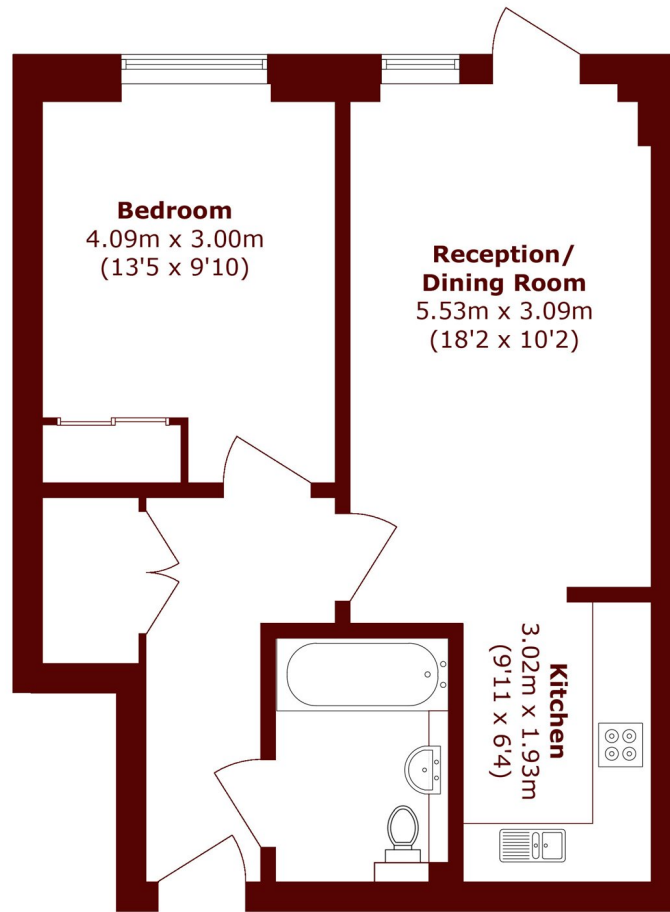

Total area (approx.): 48.6 sq. m (523.1 sq. ft)

Brixton
020 7733 4595

Energy Rating: C We aim to make our particulars both accurate and reliable. However, they are not guaranteed; nor do they form part of an offer or contract. If you require clarification on any points then please contact us, especially if you're traveling some distance to view. Please note that appliances and heating systems have not been tested and therefore no warranties can be given as to their good working order

**MARSH &
PARSONS**