



KELLETT ROAD, SW2

£650,000

Two Double Bedrooms
Open-Plan Kitchen/Reception
Private South-Facing Garden
Period Property
Close To Transport
Energy Rating: C

ABOUT THE PROPERTY

A fantastic ground floor garden flat spanning over 760 sqft comprising two double bedrooms, two bathrooms (one en-suite) and a generous open-plan kitchen, dining and reception room leading directly via bi-folding doors to a large decked private south-facing garden.

Kellett Road is a popular tree lined residential street situated in the heart of Brixton close to the vast array of independent shops, cafes, bars and restaurants of central Brixton alongside the excellent transport links into central London via Brixton Underground (Victoria Line), National Rail services and multiple bus routes.









STEP INSIDE KELLETT ROAD

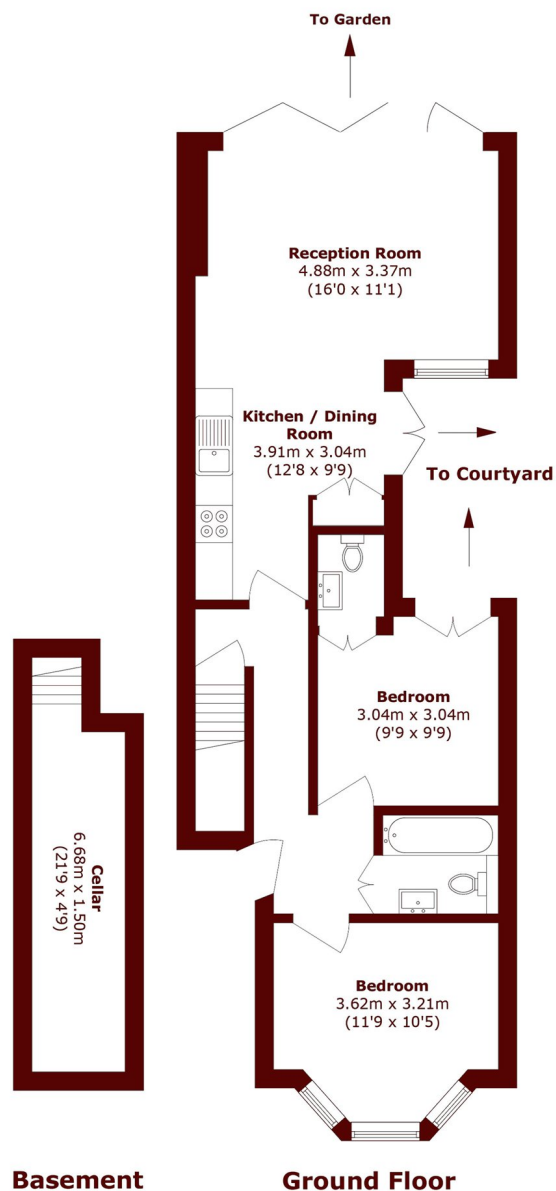

Total area (approx.): 70.8 sq. m (762.1 sq. ft)

Brixton
020 7733 4595

Energy Rating: C We aim to make our particulars both accurate and reliable. However, they are not guaranteed; nor do they form part of an offer or contract. If you require clarification on any points then please contact us, especially if you're traveling some distance to view. Please note that appliances and heating systems have not been tested and therefore no warranties can be given as to their good working order

**MARSH &
PARSONS**