



QUEENSBOROUGH TERRACE, W2

£2,300 per month

A fantastic one bedroom apartment on a prime street in Bayswater moments to Hyde Park.

One bedroom
Newly refurbished
Wooden floors

Wonderful views
Close to Hyde Park
EPC - C

@marshandparsons
marshandparsons.co.uk

MARSH &
PARSONS

STEP INSIDE QUEENSBOROUGH TERRACE

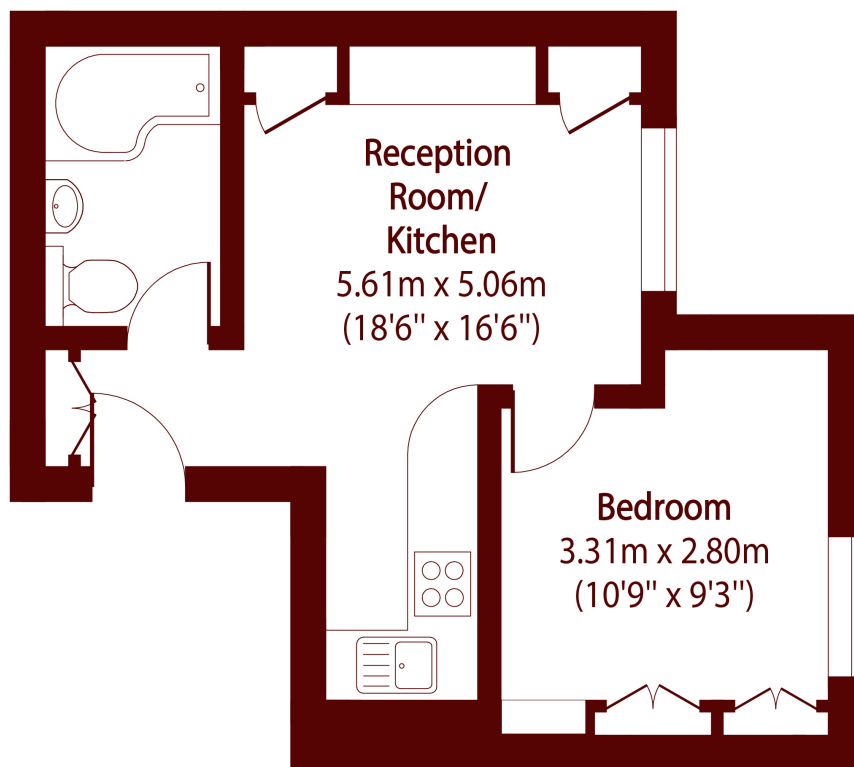

Total area (approx): 29.16 sq m (314 sq. ft)

Notting Hill
020 7313 6910

Energy Rating: C We aim to make our particulars both accurate and reliable. However, they are not guaranteed; nor do they form part of an offer or contract. If you require clarification on any points then please contact us, especially if you're traveling some distance to view. Please note that appliances and heating systems have not been tested and therefore no warranties can be given as to their good working order

MARSH &
PARSONS