



Westbourne Grove Terrace, W2

£350,000

 0  1  1  E

- No Onward Chain
- Separate Kitchen

- Leasehold
- Studio

- Lift
- Great Location

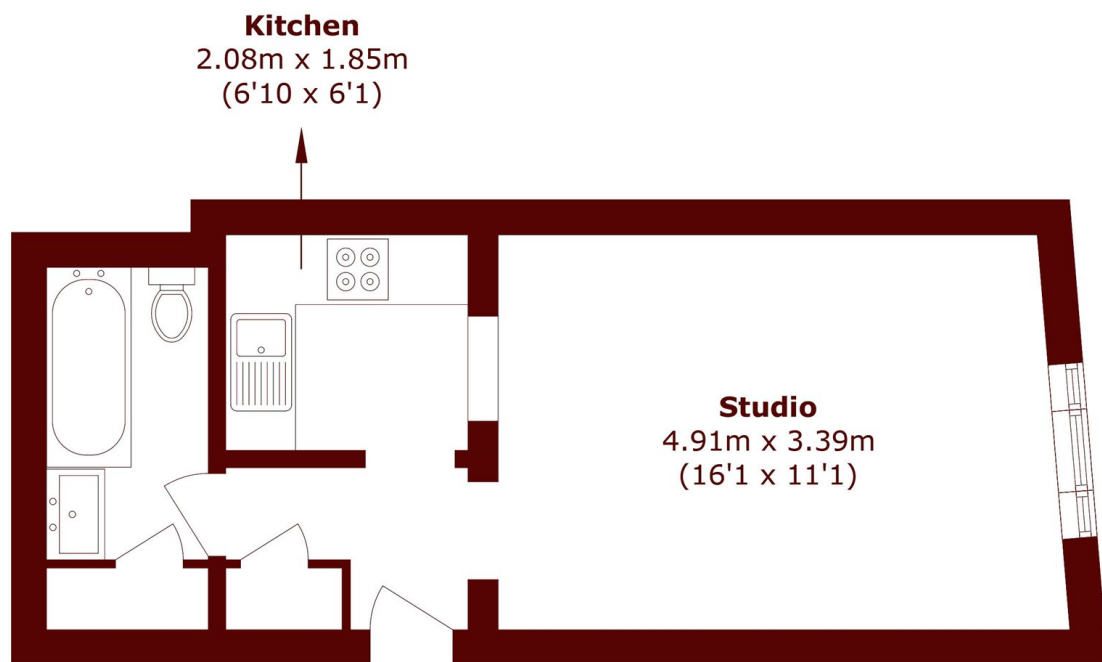

Total area (approx.): 28.8 sq. m (310.0 sq. ft)

Marsh & Parsons Notting Hill

2-6 Kensington Park Road,
London, W11 3BU
020 7313 2890