



EFFRA ROAD, SW2

£550,000

Two Double Bedrooms
Large Private Garden
Share Of Freehold
Chain Free
Period Property
Energy Rating: D

@marshandparsons
marshandparsons.co.uk

MARSH &
PARSONS

ABOUT THE PROPERTY

Set within an impressive and handsome period conversion, this spacious two double bedroom garden flat offers over 900 sq ft of internal living space comprising a generous open plan living-kitchen-dining room with direct access to a large private garden, two well-proportioned double bedrooms and a contemporary bathroom.

Located moments from the heart of Brixton with its vast array of independent shops, cafes, bars and restaurants and the open green spaces of Brockwell Park nearby alongside the excellent transport links into central London via Brixton Underground (Victoria Line), National Rail services and multiple bus routes.









STEP INSIDE EFFRA ROAD

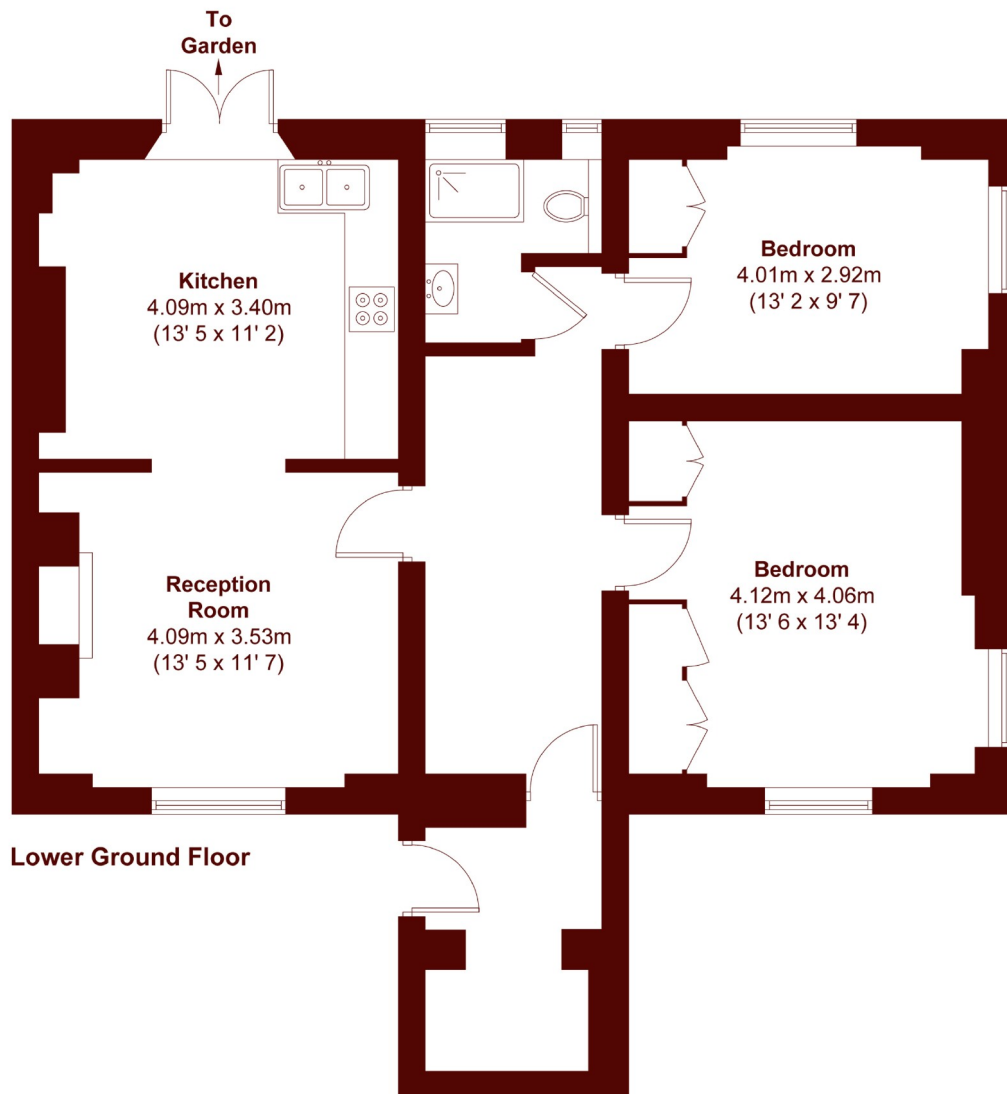

APPROX. GROSS INTERNAL FLOOR AREA
913 SQFT / 84.8 SQM

Brixton
020 7733 4595

Energy Rating: D We aim to make our particulars both accurate and reliable. However, they are not guaranteed; nor do they form part of an offer or contract. If you require clarification on any points then please contact us, especially if you're traveling some distance to view. Please note that appliances and heating systems have not been tested and therefore no warranties can be given as to their good working order

**MARSH &
PARSONS**