



Addisland Court, W14

£1,038 per week



- Open Plan Reception
- Three Bedrooms
- Two Bathrooms
- Lift
- Porter
- Fourth Floor





ABOUT THE PROPERTY

This charming light-filled apartment occupies one of the best positions in Addisland Court. The property features an open-plan modern fully integrated kitchen and dining area, ideal for entertaining.

Addisland Court is a short walk from the amenities of Holland Park Avenue, Notting Hill as well as Westfield Shopping Centre and High Street Kensington.



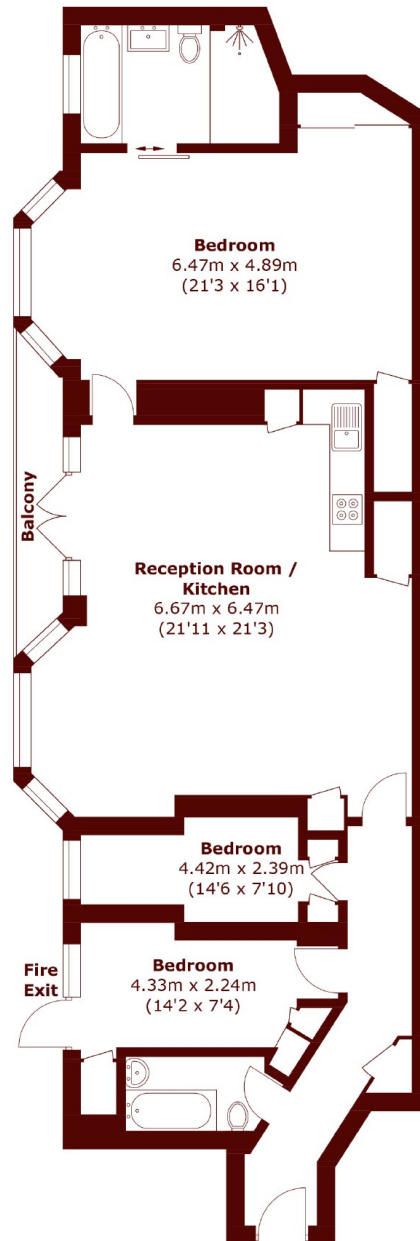

Total area (approx.): 108.7 sq. m (1,170.0 sq. ft)
Balcony: 3.7 sq. m (39.8 sq. ft)

Marsh & Parsons Holland Park

57 Norland Square, London,
W11 4QJ
020 7605 6890