



JEDDO ROAD, W12

£650,000

A charming and characterful two-bedroom maisonette set on a quiet residential road, offering bright and well-proportioned living throughout. This appealing home features a spacious open-plan kitchen/reception

Private garden

Spacious kitchen

Open-plan living

Two bedrooms

STEP INSIDE JEDDO ROAD

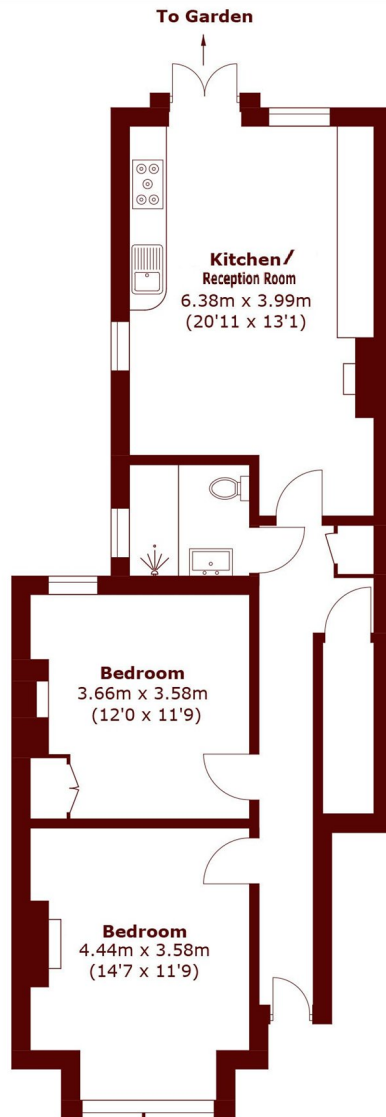

Total area (approx.): 69.8 sq. m (751.3 sq. ft)

Askew Road
020 8102 0123

Energy Rating: We aim to make our particulars both accurate and reliable. However, they are not guaranteed; nor do they form part of an offer or contract. If you require clarification on any points then please contact us, especially if you're traveling some distance to view. Please note that appliances and heating systems have not been tested and therefore no warranties can be given as to their good working order

**MARSH &
PARSONS**