



WOOLWICH ROAD, SE10

£1,650 per month

Modern one bedroom flat

Second floor

Open plan

Private balcony

Open plan kitchen

Energy rating: c

@marshandparsons
marshandparsons.co.uk

MARSH &
PARSONS



ABOUT THE PROPERTY

A beautifully presented second floor modern flat situated within the sought after Union Park development. The interior briefly comprises an open plan kitchen, spacious living room with direct access to a large private balcony, double bedroom and a modern bathroom suite with fitted shower.

Maze Hill mainline station and Greenwich's royal park are both a short walk away, as well as a wide range of shops. North Greenwich tube station and Greenwich town centre are within walking distance or a very short bus ride away.



STEP INSIDE WOOLWICH ROAD

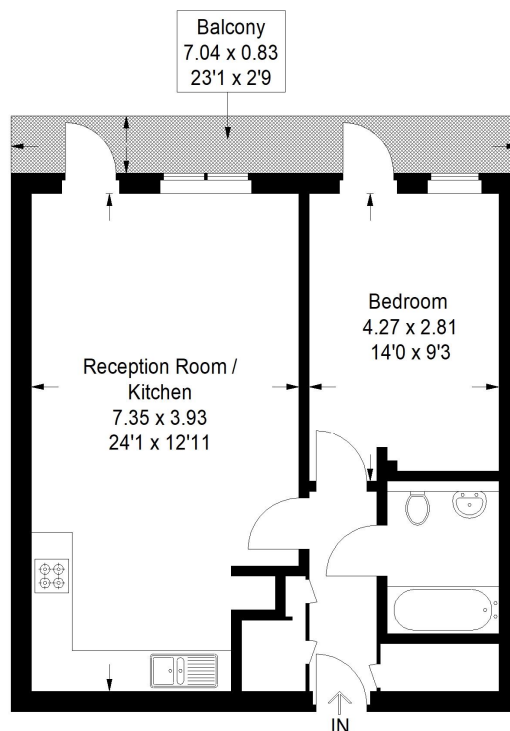

Second Floor

**Approximate Gross Internal Area
51.2 sq m / 551 sq ft**



Greenwich
020 8815 2230

Energy Rating: C We aim to make our particulars both accurate and reliable. However, they are not guaranteed; nor do they form part of an offer or contract. If you require clarification on any points then please contact us, especially if you're traveling some distance to view. Please note that appliances and heating systems have not been tested and therefore no warranties can be given as to their good working order

**MARSH &
PARSONS**