



PARKSIDE AVENUE, SE10

£375,000

Two bedrooms
Spacious living room
Modern bathroom suite
Private balcony
Views of city skyline
Energy rating: c

@marshandparsons
marshandparsons.co.uk

MARSH &
PARSONS



ABOUT THE PROPERTY

The interior comprises two double bedrooms featuring ample space for storage units, modern bathroom suite with fitted shower over bath, very spacious living room, which offers dining space, direct access to a private balcony with views of the city skyline and an open plan kitchen. Added advantages include wood floors, floor to ceiling double glazed windows and a large storage cupboard. Residents benefit from having a concierge on-site.

Greenwich town centre is a short walk away, where you will find a wide choice of shops, river front pubs and restaurants, the famous covered market and Royal park.



STEP INSIDE PARKSIDE AVENUE

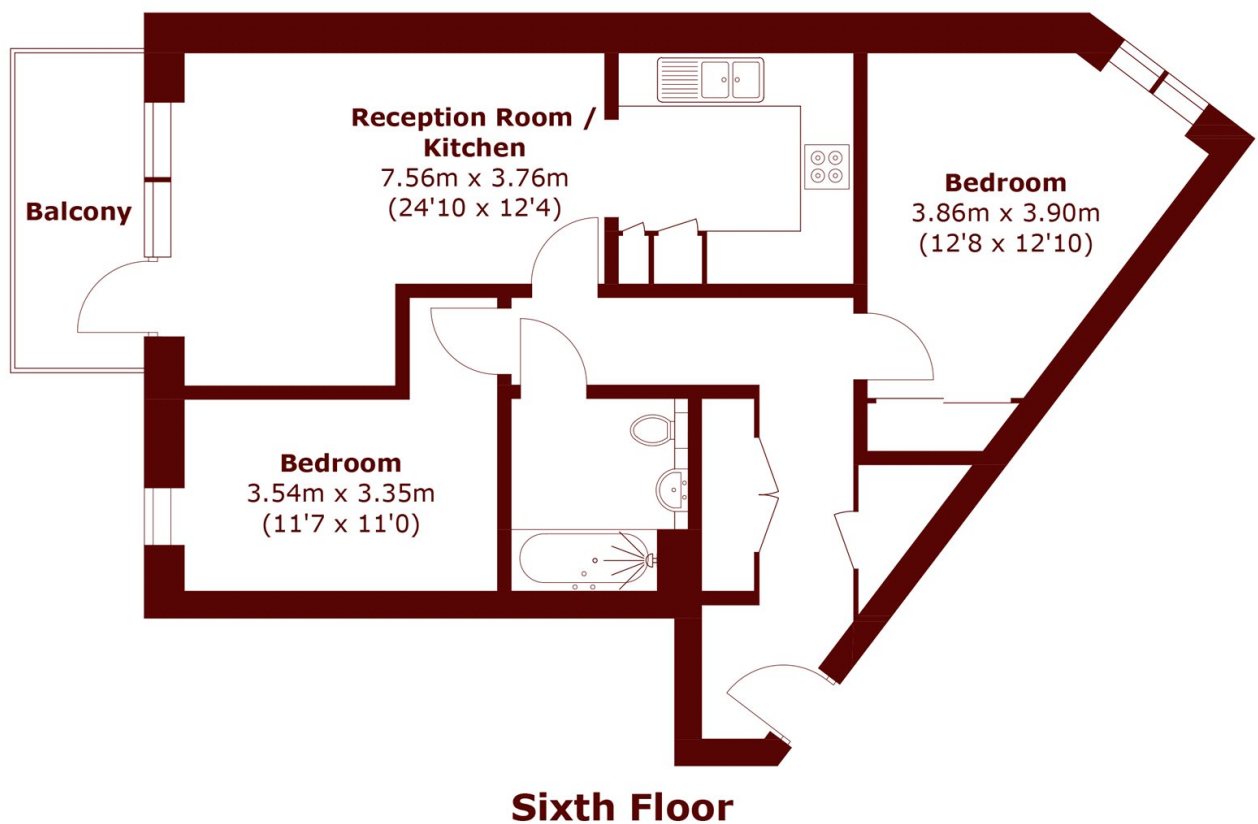

Total area (approx.): 63.4 sq. m (682.4 sq. ft)
Balcony: 5.2 sq. m (56.0 sq. ft)

Greenwich
020 8312 8312

Energy Rating: C We aim to make our particulars both accurate and reliable. However, they are not guaranteed; nor do they form part of an offer or contract. If you require clarification on any points then please contact us, especially if you're traveling some distance to view. Please note that appliances and heating systems have not been tested and therefore no warranties can be given as to their good working order

MARSH &
PARSONS