



## CHISWICK VILLAGE, W4

£430,000

Ground Floor  
Two Bedrooms  
Share Of Freehold  
Communal Gardens  
Close To Transport  
No Onward Chain

@marshandparsons  
marshandparsons.co.uk

MARSH &  
PARSONS



# ABOUT THE PROPERTY

A well-presented two double bedroom, ground floor apartment within this popular development. With share of freehold, maintained communal grounds and no onward chain, This block does not back onto the railway.

Chiswick Village is within half a mile of Gunnersbury Station (District & Overground), Kew Bridge Station (GWR) and the M4/A4 providing excellent access into and out of London. Highly regarded schools such as Strand on the Green, local amenities, restaurants and the River Thames are also close by.



# STEP INSIDE CHISWICK VILLAGE

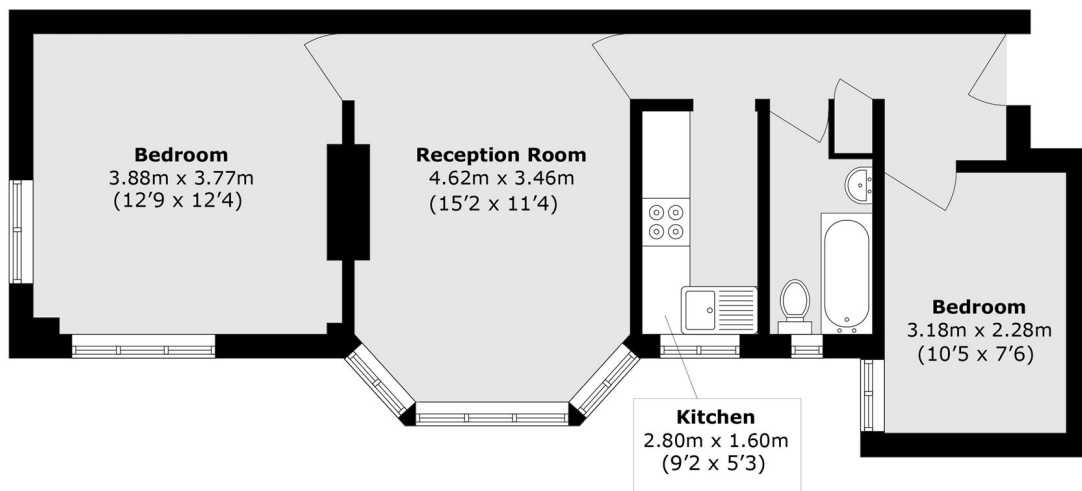

Total area (approx.): 52.6 sq. m (566.1 sq. ft)

Chiswick  
020 8994 2556

Energy Rating: D We aim to make our particulars both accurate and reliable. However, they are not guaranteed; nor do they form part of an offer or contract. If you require clarification on any points then please contact us, especially if you're traveling some distance to view. Please note that appliances and heating systems have not been tested and therefore no warranties can be given as to their good working order

MARSH &  
PARSONS