



ST. JULIANS ROAD, NW6

£475,000

Two Bedrooms
Raised Ground Floor
High Ceilings
Good Condition Throughout
Chain-Free
Close To Local Amenities

@marshandparsons
marshandparsons.co.uk

MARSH &
PARSONS



ABOUT THE PROPERTY

This charming raised ground floor conversion flat in a period building provides two bedrooms, with high ceilings and flooded with light. The open plan kitchen and reception room is located to the front occupying the bay window, with built-in storage, good condition throughout, and is available chain-free.

St. Julians Road is located close shops, cafes, restaurants and bars on Salisbury Road and the High Road, with the green open spaces of Queen's Park nearby. Transport links include Queen's Park (Bakerloo), Brondesbury (Overground), and Kilburn High Road (Overground).



STEP INSIDE ST. JULIANS ROAD

St. Julians Road, NW6

APPROX. GROSS INTERNAL FLOOR AREA 527 SQFT / 48.96 SQM

Key :
CH - Ceiling Height

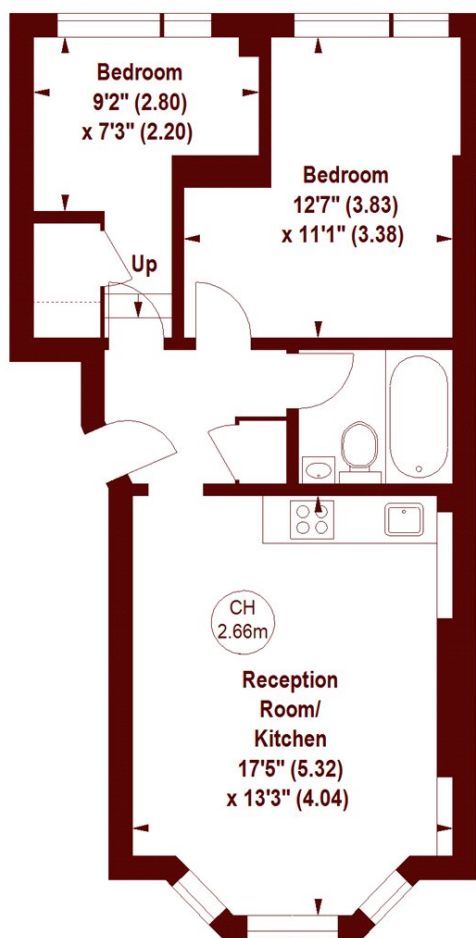

GROUND FLOOR

The floor plan is not to scale and measurements and areas shown are approximate and therefore should be used for illustrative purposes only.

The plan has been prepared in accordance with the RICS code of Measuring Practice and whilst we have confidence in the information produced, it must not be relied on.

If there is any aspect of particular importance, you should carry out or commission your own inspection of the property.

Copyright of FeaturePRO.

Queen's Park
020 7624 4513

Energy Rating: C We aim to make our particulars both accurate and reliable. However, they are not guaranteed; nor do they form part of an offer or contract. If you require clarification on any points then please contact us, especially if you're traveling some distance to view. Please note that appliances and heating systems have not been tested and therefore no warranties can be given as to their good working order

MARSH &
PARSONS