



BRONDESBURY ROAD, NW6

£1,400,000

Freehold
Two Double Bedrooms
Excellent Condition Throughout
Garage & Studio
Gated Off-Street Parking
Prime Location

@marshandparsons
marshandparsons.co.uk

MARSH &
PARSONS

ABOUT THE PROPERTY

Showcased in immaculate condition is this two double bedroom freehold house, arranged over three floors and with the addition of a garage, studio room, and gated off-street parking. The property is accessed through a secure side gate with its own entrance, has a spacious reception room and modern fully integrated kitchen with an island, a vaulted ceiling bedroom and walk-in dressing room with an en suite, and is located in a prime area of Queen's Park.

Situated close to the shops, cafes, bars and restaurants on Salisbury Road, transport links include Queen's Park and Brondesbury Park.









STEP INSIDE BRONDESURY ROAD

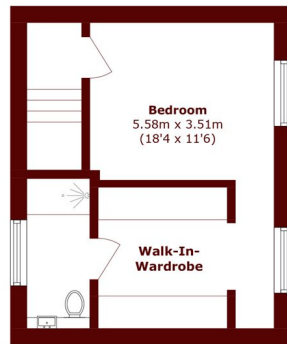

Second Floor

To Garden



Ground Floor



Ground Floor

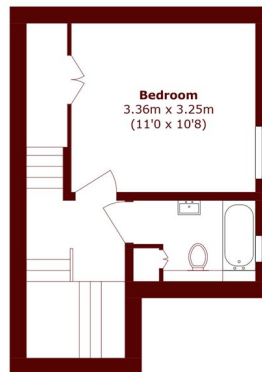

First Floor

Total area (approx.): 83.6 sq. m (899.8 sq. ft)

Outbuilding area (approx.): 15.5 sq. m (166.8 sq. ft)

Queen's Park
020 7624 4513

Energy Rating: D We aim to make our particulars both accurate and reliable. However, they are not guaranteed; nor do they form part of an offer or contract. If you require clarification on any points then please contact us, especially if you're traveling some distance to view. Please note that appliances and heating systems have not been tested and therefore no warranties can be given as to their good working order

MARSH &
PARSONS