



BERNARD ASHLEY DRIVE, SE7

£300,000

Flat
Two bedrooms
One reception room
One bathroom
Communal garden
Energy rating: c

@marshandparsons
marshandparsons.co.uk

MARSH &
PARSONS



ABOUT THE PROPERTY

Guide Price £300,000-£325,000

Located in a quiet cul-de-sac in Charlton, SE7, this well-presented two bedroom ground floor apartment is an ideal first time purchase. The property features an entrance hall, two bedrooms, a modern bathroom, a bright lounge overlooking the communal gardens, and a fitted kitchen. Residents also enjoy access to well-maintained communal grounds and secure gated parking.

Close to Woolwich Road, the property is within easy reach of Greenwich Shopping Park, local supermarkets, and excellent transport links, including buses to North Greenwich and Woolwich Arsenal, plus direct rail services from Charlton Station to Central London.



STEP INSIDE

BERNARD ASHLEY DRIVE

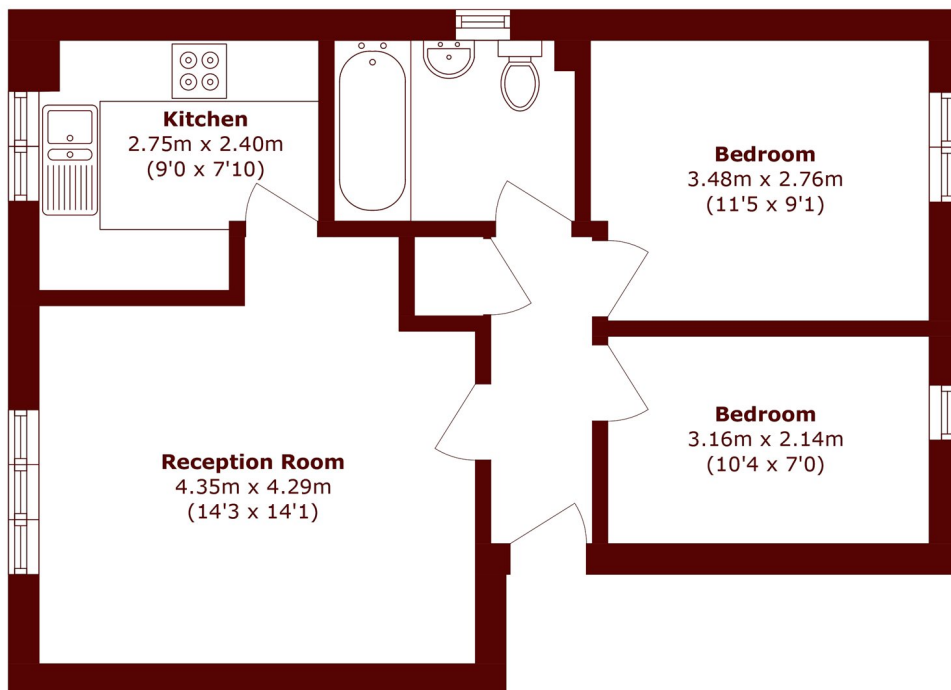

Total area (approx.): 48.3 sq. m (519.9 sq. ft)

Charlton
020 8293 0454

Energy Rating: C We aim to make our particulars both accurate and reliable. However, they are not guaranteed; nor do they form part of an offer or contract. If you require clarification on any points then please contact us, especially if you're traveling some distance to view. Please note that appliances and heating systems have not been tested and therefore no warranties can be given as to their good working order

**MARSH &
PARSONS**