



OVERCLIFF ROAD, SE13

£460,000

Victorian conversion
Two double bedrooms
Garden flat
Share of Freehold
Close to transport links
Energy rating: D

@marshandparsons
marshandparsons.co.uk

MARSH &
PARSONS



ABOUT THE PROPERTY

Share of Freehold Victorian conversion flat, moments from Hilly Fields Park. Set on a quiet, tree lined street, the property has two double bedrooms, separate kitchen and access to its own private garden.

Situated on the popular Overcliff Road in Ladywell, the property is within easy reach of Hilly Fields, local cafés, shops and everyday amenities. Excellent transport links are available from nearby Ladywell, Lewisham and St Johns stations, offering swift connections to Central London and Canary Wharf.



STEP INSIDE OVERCLIFF ROAD

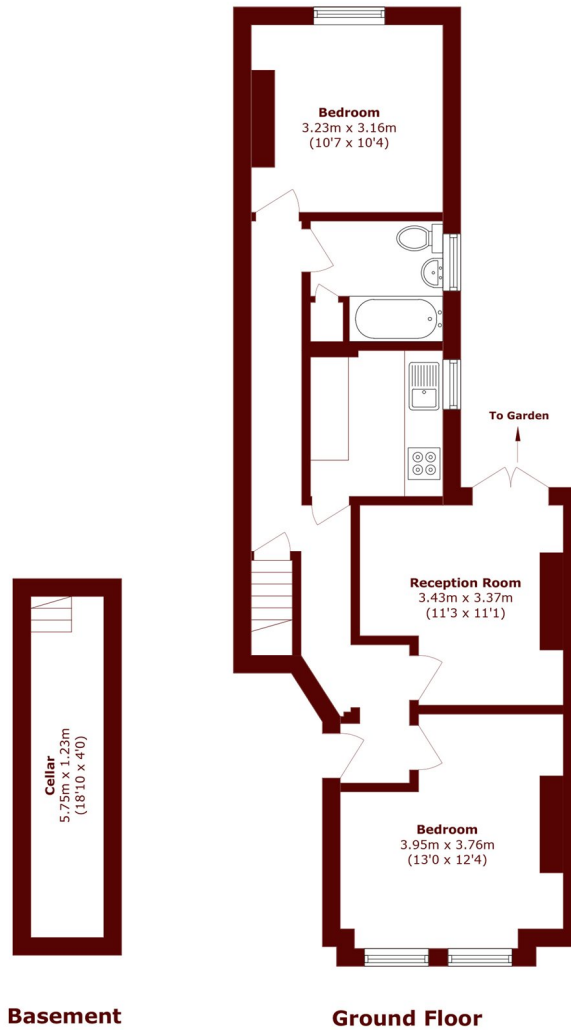

Total area (approx.): 65.1 sq. m (700.7 sq. ft)

Brockley
020 8629 8164

Energy Rating: D We aim to make our particulars both accurate and reliable. However, they are not guaranteed; nor do they form part of an offer or contract. If you require clarification on any points then please contact us, especially if you're traveling some distance to view. Please note that appliances and heating systems have not been tested and therefore no warranties can be given as to their good working order

**MARSH &
PARSONS**