



## SUTHERLAND AVENUE, W9

£1,075,000

An exceptionally spacious two double bedroom garden flat set on one of Maida Vale's most sought-after roads, extending to approximately 956 sq ft. Beautifully refurbished throughout, the property features a bright open

Period Conversion  
Two Bedrooms  
Excellent Condition

Extended to Rear  
Two Bathrooms  
Private Entrance

# STEP INSIDE SUTHERLAND AVENUE

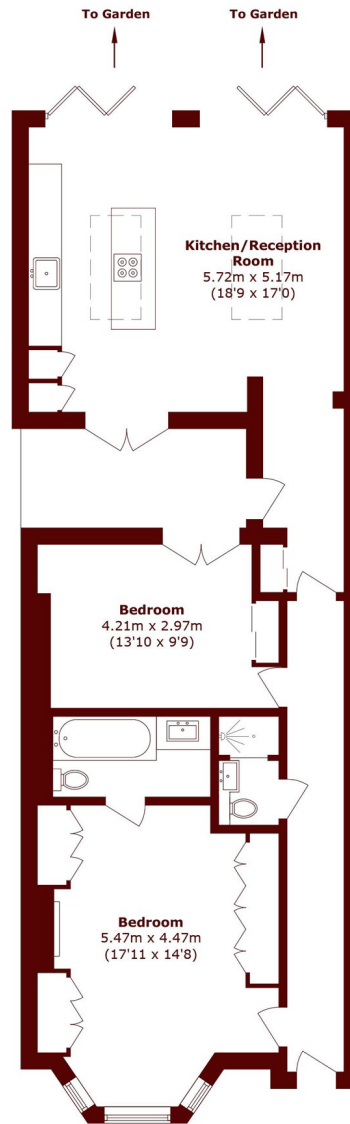

## Lower Ground Floor

Total area (approx.): 88.9 sq. m (956.9 sq. ft)

Little Venice  
020 7993 3050

Energy Rating: We aim to make our particulars both accurate and reliable. However, they are not guaranteed; nor do they form part of an offer or contract. If you require clarification on any points then please contact us, especially if you're traveling some distance to view. Please note that appliances and heating systems have not been tested and therefore no warranties can be given as to their good working order

MARSH &  
PARSONS