



HETHERINGTON ROAD, SW4

£625,000

Victorian conversion flat
Generous living space
West-facing garden
Long lease - 187 years
Quiet residential street
Chain free

@marshandparsons
marshandparsons.co.uk

MARSH &
PARSONS



ABOUT THE PROPERTY

A superb two double bedroom garden flat on a popular residential street, close to Clapham Common and Brixton. Long lease and offered chain free.

This bright and spacious flat benefits from a superb 187-year lease and generous living space opening onto a lovely west-facing garden. Hetherington Road is a quiet residential street, ideally positioned for the amenities of Clapham Common, Abbeville Village and vibrant Brixton, all offering excellent transport links into the City and West End.

Nearby stations include Clapham North and Brixton Underground (Northern & Victoria lines), along with



STEP INSIDE HETHERINGTON ROAD

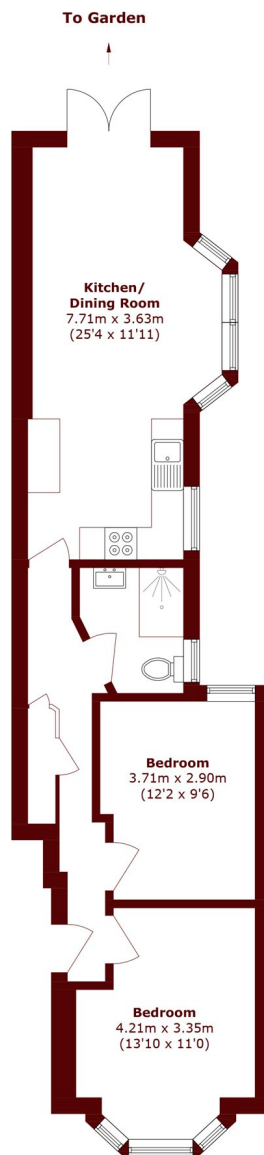

Total area (approx.): 61.2 sq. m (658.7 sq. ft)

Clapham
020 7501 3666

Energy Rating: C We aim to make our particulars both accurate and reliable. However, they are not guaranteed; nor do they form part of an offer or contract. If you require clarification on any points then please contact us, especially if you're traveling some distance to view. Please note that appliances and heating systems have not been tested and therefore no warranties can be given as to their good working order

**MARSH &
PARSONS**