



SOMERTON ROAD, NW2

£325,000

A stunning high-specification newly refurbished one-bedroom home, finished to an exceptional standard.

Open plan living
Natural light
One bedroom

Newly renovated
Private parking space
Boarded loft space

STEP INSIDE SOMERTON ROAD

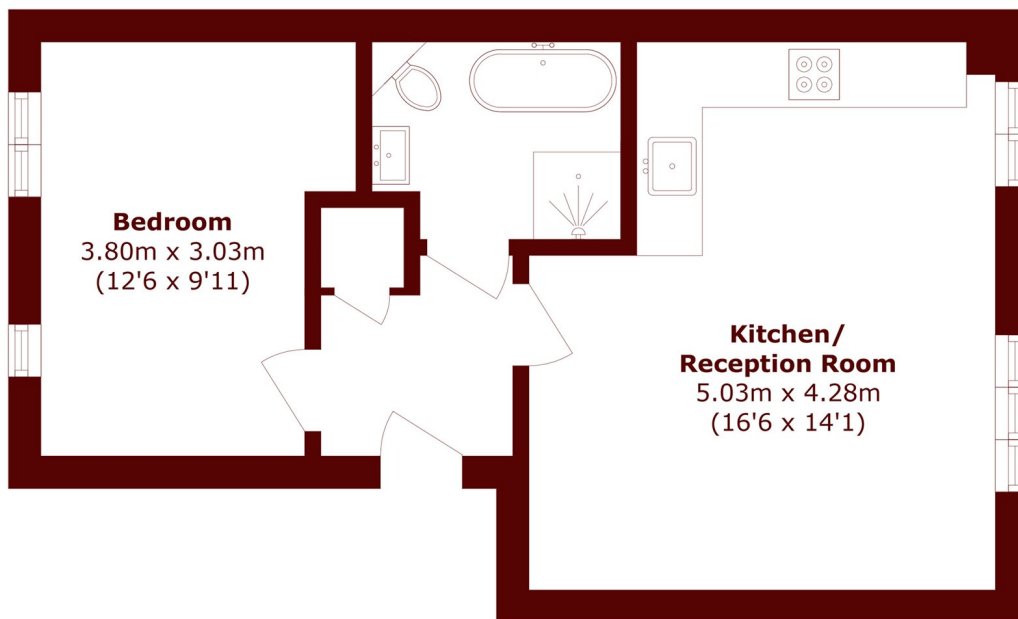

Total area (approx.): 38.5 sq. m (414.4 sq. ft)

Willesden Green
020 8451 0420

Energy Rating: B We aim to make our particulars both accurate and reliable. However, they are not guaranteed; nor do they form part of an offer or contract. If you require clarification on any points then please contact us, especially if you're traveling some distance to view. Please note that appliances and heating systems have not been tested and therefore no warranties can be given as to their good working order

**MARSH &
PARSONS**