



NEVERN SQUARE, SW5

£700,000

Two double bedrooms
Refurbished kitchen
Refurbished bathroom
Private garden square
Victorian conversion
Energy rating c

@marshandparsons
marshandparsons.co.uk

MARSH &
PARSONS



ABOUT THE PROPERTY

A charming two double bedroom apartment positioned within this attractive Victorian building, directly across from the beautiful gardens of Nevern Square. The flat itself occupies an elevated position overlooking the lovely square, boasting a dual aspect layout, extending to approx. 688 sq ft. The property also benefits from a refurbished kitchen and bathroom.

The square is located close to the many amenities of Earls Court Road and Gloucester Road and the plethora of restaurants, bars and shops on High Street Kensington, Old Brompton Road, and the Fulham Road. Earl's Court Underground station (District and Piccadilly lines) is also nearby and provides a link into London's West End and



STEP INSIDE NEVERN SQUARE

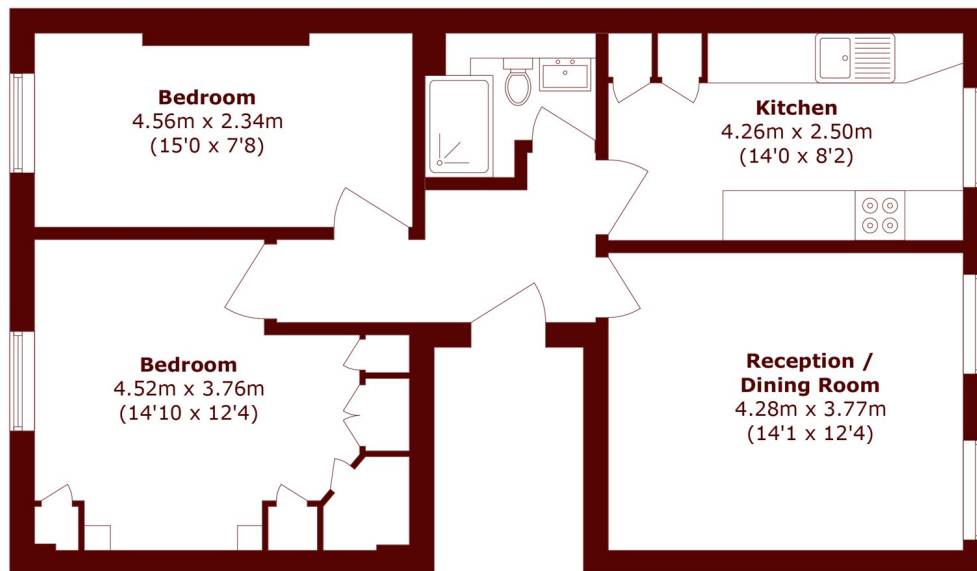

Total area (approx.): 63.2 sq. m (680.2 sq. ft)

Earls Court
020 7590 0800

Energy Rating: C We aim to make our particulars both accurate and reliable. However, they are not guaranteed; nor do they form part of an offer or contract. If you require clarification on any points then please contact us, especially if you're traveling some distance to view. Please note that appliances and heating systems have not been tested and therefore no warranties can be given as to their good working order

**MARSH &
PARSONS**