



NEW CROSS ROAD, SE14

£295,000

First Floor One Bedroom Apartment

Close To Transport

Secure Gated Development

Communal Garden

Unallocated Parking

Energy rating: C

@marshandparsons
marshandparsons.co.uk

MARSH &
PARSONS



ABOUT THE PROPERTY

Bright and spacious first floor one bedroom apartment set within a secure gated development in New Cross. Further benefits include access to a communal garden and parking on a first come first served basis. Excellent buy-to-let potential, currently achieving a yield of 7+% making it an attractive investment opportunity. Chain Free.

Theatre Place is located a short walk from several train stations, including New Cross (mainline and overground), Deptford and Deptford Bridge.



STEP INSIDE NEW CROSS ROAD

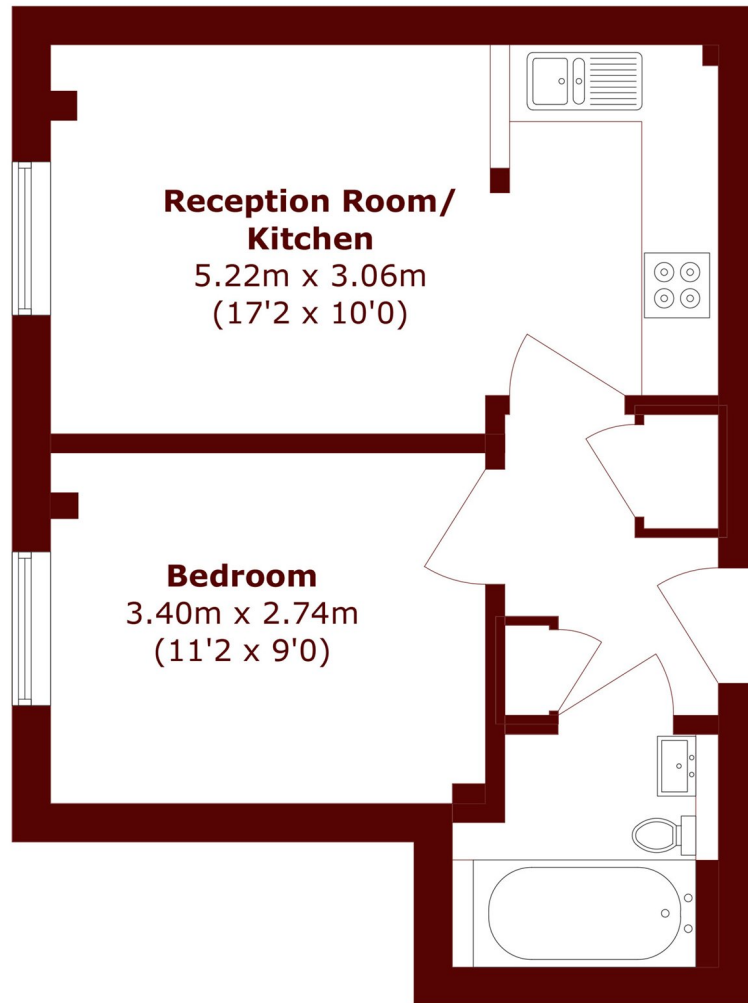

Total area (approx.): 33.6 sq. m (361.6 sq. ft)

Brockley
020 8629 8164

Energy Rating: C We aim to make our particulars both accurate and reliable. However, they are not guaranteed; nor do they form part of an offer or contract. If you require clarification on any points then please contact us, especially if you're traveling some distance to view. Please note that appliances and heating systems have not been tested and therefore no warranties can be given as to their good working order

**MARSH &
PARSONS**