



WOODROW, SE18

£240,000

Flat
One bedroom
One reception room
One bathroom
Warehouse conversion
Energy rating: b

@marshandparsons
marshandparsons.co.uk

MARSH &
PARSONS



ABOUT THE PROPERTY

This stunning top floor apartment forms part of a unique warehouse conversion, offering a luxury finish, impressive high ceilings, and an abundance of natural light. Every home within this boutique development has its own individual layout and character, and this apartment is no exception. The property features a bright double bedroom with en suite shower room, stylish feature radiators, and large windows that enhance the sense of space. The contemporary white kitchen has been thoughtfully designed with quality finishes, complemented by solid wood flooring and bespoke bathroom fittings. It also offers excellent rental potential for investors, with an estimated income of £1,400pcm.



STEP INSIDE WOODROW

Third Floor

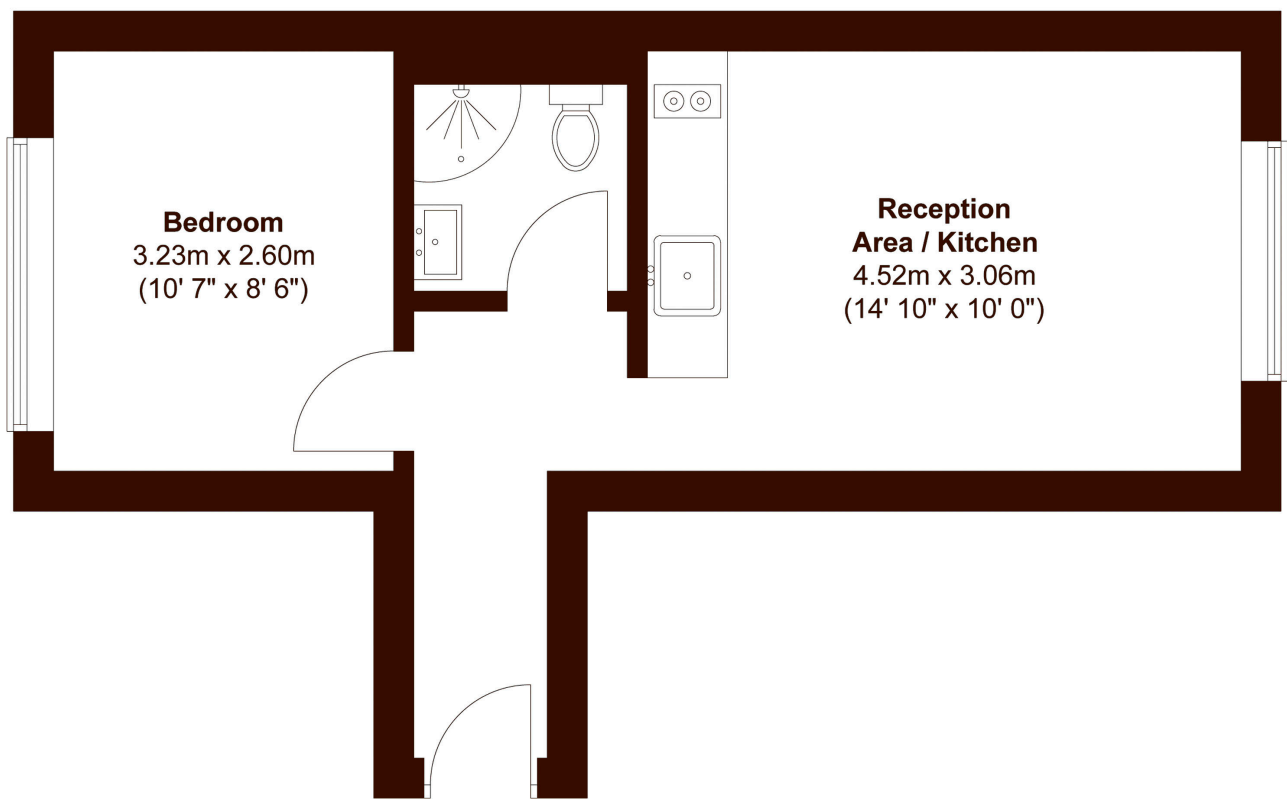

Total area (approx.) : 30.6 sq. m (329 sq. ft)

Charlton
020 8293 0454

Energy Rating: B We aim to make our particulars both accurate and reliable. However, they are not guaranteed; nor do they form part of an offer or contract. If you require clarification on any points then please contact us, especially if you're traveling some distance to view. Please note that appliances and heating systems have not been tested and therefore no warranties can be given as to their good working order

**MARSH &
PARSONS**