



CORBET GARDENS, W3

£425,000

5th floor with bright aspect
South-west facing balcony
Underground parking
High-end specifications
Ample storage throughout
Energy rating: b

@marshandparsons
marshandparsons.co.uk

MARSH &
PARSONS



ABOUT THE PROPERTY

Situated in the heart of Acton Gardens, this bright and immaculately presented one-bedroom apartment is on the top floor and enjoys views over Bollo Park. The property offers a well-proportioned layout finished to a high specification. It benefits from a south-west facing private balcony, lift access, underfloor heating, a long lease, ample storage, and an underground parking space with an EV charger.

Excellent transport links are available via Acton Town station (District and Piccadilly lines), South Acton station (Overground), and Acton Main Line (Elizabeth Line), all within walking distance, providing fast and convenient access into central London and beyond.



STEP INSIDE CORBET GARDENS

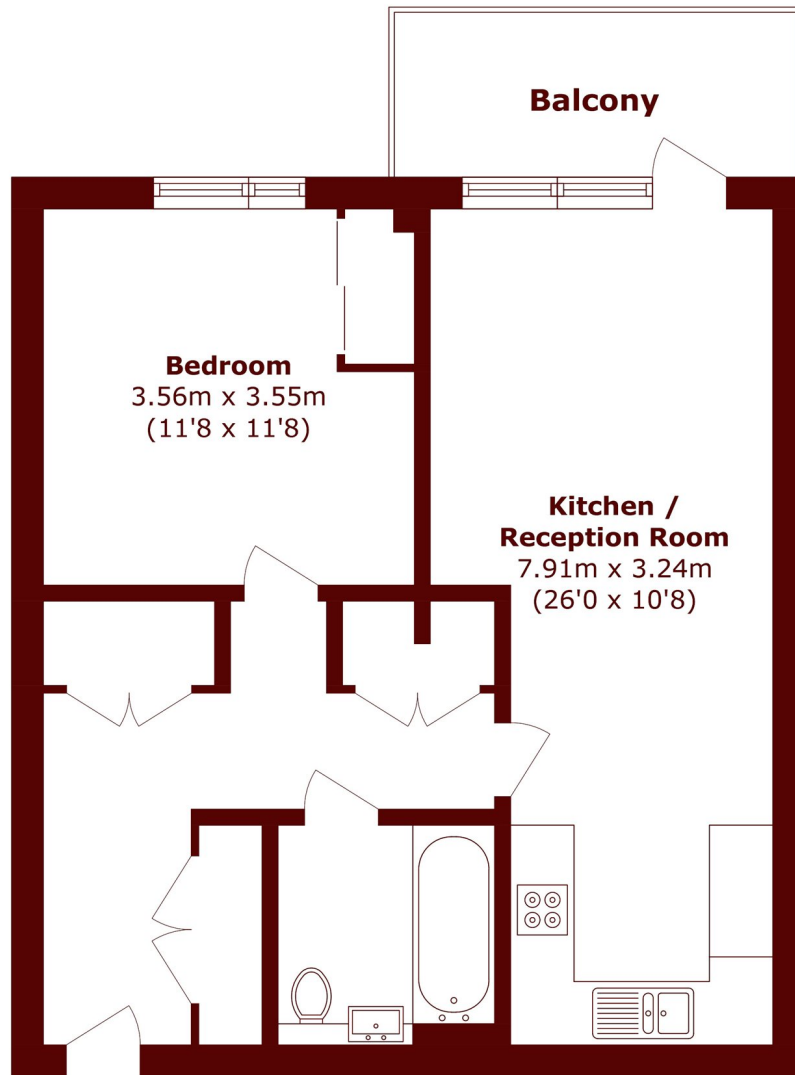

Total area (approx.): 54.5 sq. m (586.6 sq. ft)

Balcony area (approx.): 6.3 sq. m (67.8 sq. ft)

Chiswick
020 8994 2556

Energy Rating: B We aim to make our particulars both accurate and reliable. However, they are not guaranteed; nor do they form part of an offer or contract. If you require clarification on any points then please contact us, especially if you're traveling some distance to view. Please note that appliances and heating systems have not been tested and therefore no warranties can be given as to their good working order

MARSH &
PARSONS