



RAYMOND ROAD, SW19

£3,000 per month

Two bedrooms
Two bathrooms
Modern kitchen
Split-level maisonette
Communal gardens
Energy rating: c

@marshandparsons
marshandparsons.co.uk

MARSH &
PARSONS



ABOUT THE PROPERTY

A recently refurbished two bedroom split level maisonette, offering a spacious reception room, modern fitted kitchen, ground floor cloakroom, master bedroom with en suite shower room, a further double bedroom, bathroom and direct access to communal gardens.

The property is located under half a mile from Wimbledon Town Centre and Station.



STEP INSIDE RAYMOND ROAD

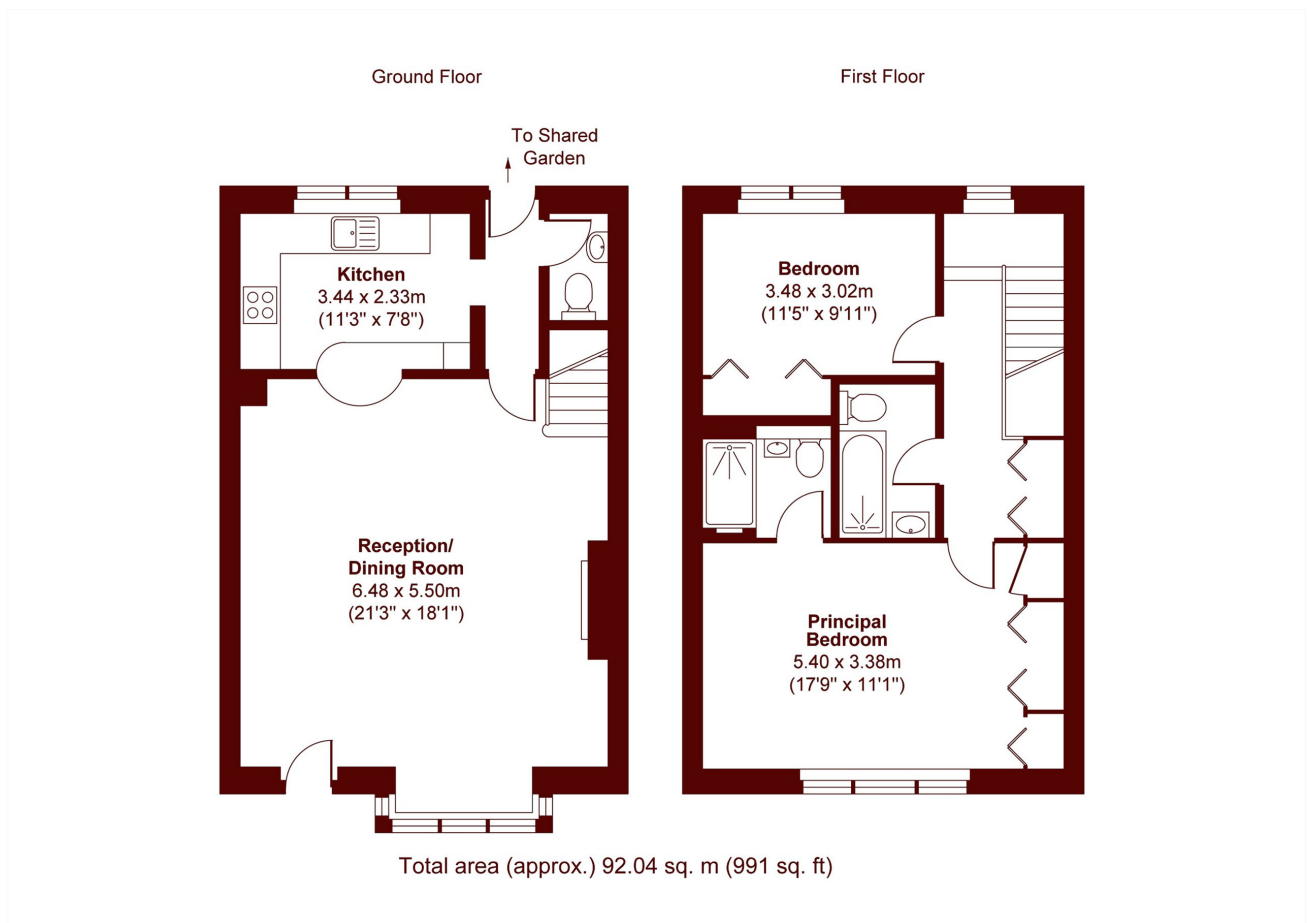

Wimbledon
020 8879 6661

Energy Rating: C We aim to make our particulars both accurate and reliable. However, they are not guaranteed; nor do they form part of an offer or contract. If you require clarification on any points then please contact us, especially if you're traveling some distance to view. Please note that appliances and heating systems have not been tested and therefore no warranties can be given as to their good working order

MARSH &
PARSONS