



MOWBRAY ROAD, NW6

£350,000

Situated in the Mapesbury conservation area, this ground-floor two-bedroom flat offers ample storage, a spacious double bedroom with direct access to a communal garden.

Two Bedrooms
Off Street Parking
Ground Floor

Outside Space
One Bathroom
Bright Living Room

@marshandparsons
marshandparsons.co.uk

MARSH &
PARSONS

STEP INSIDE MOWBRAY ROAD

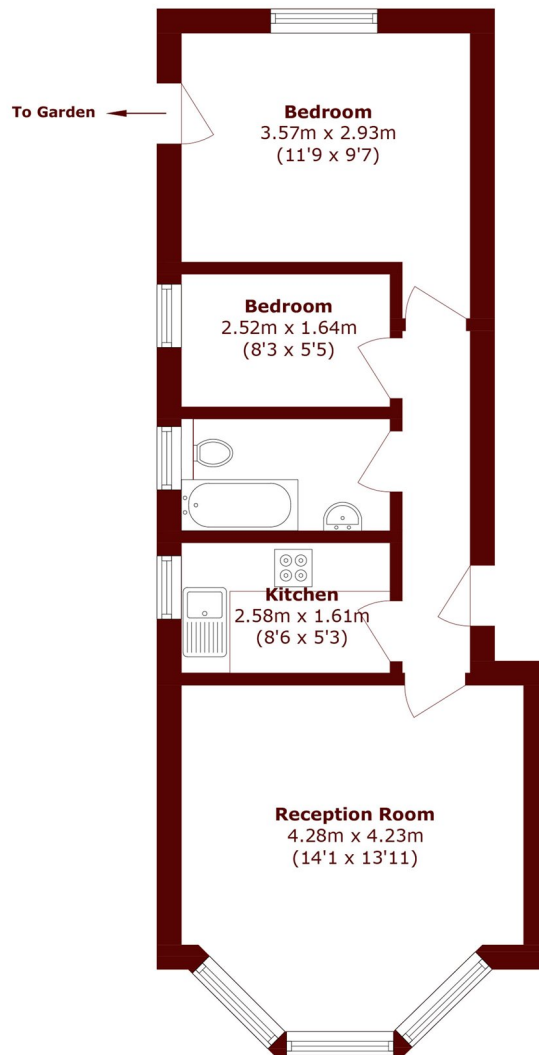

Total area (approx.): 44.9 sq. m (483.3 sq. ft)

Willesden Green
020 8451 0420

Energy Rating: We aim to make our particulars both accurate and reliable. However, they are not guaranteed; nor do they form part of an offer or contract. If you require clarification on any points then please contact us, especially if you're traveling some distance to view. Please note that appliances and heating systems have not been tested and therefore no warranties can be given as to their good working order

**MARSH &
PARSONS**