



OAKLEY STREET, SW3

£900,000

Share of Freehold
Full width private balcony
First floor
Two bedrooms
High ceilings
Incredibly bright

@marshandparsons
marshandparsons.co.uk

MARSH &
PARSONS



ABOUT THE PROPERTY

A fabulous first floor, two bedroom apartment, spread across the full width of this grand, Grade II listed building, moments from the Kings Road with its own private balcony.

The accommodation comprises: communal entrance hall, private reception hall, reception room with access to the balcony and separate kitchen with appliances. The principal bedroom has fitted wardrobes and also has access to the full width balcony. There is also a second bedroom with fitted wardrobes and family bathroom.

Oakley Street is a wide street that forms part of the new "cycling quiet ways" and runs between King's Road and



STEP INSIDE OAKLEY STREET

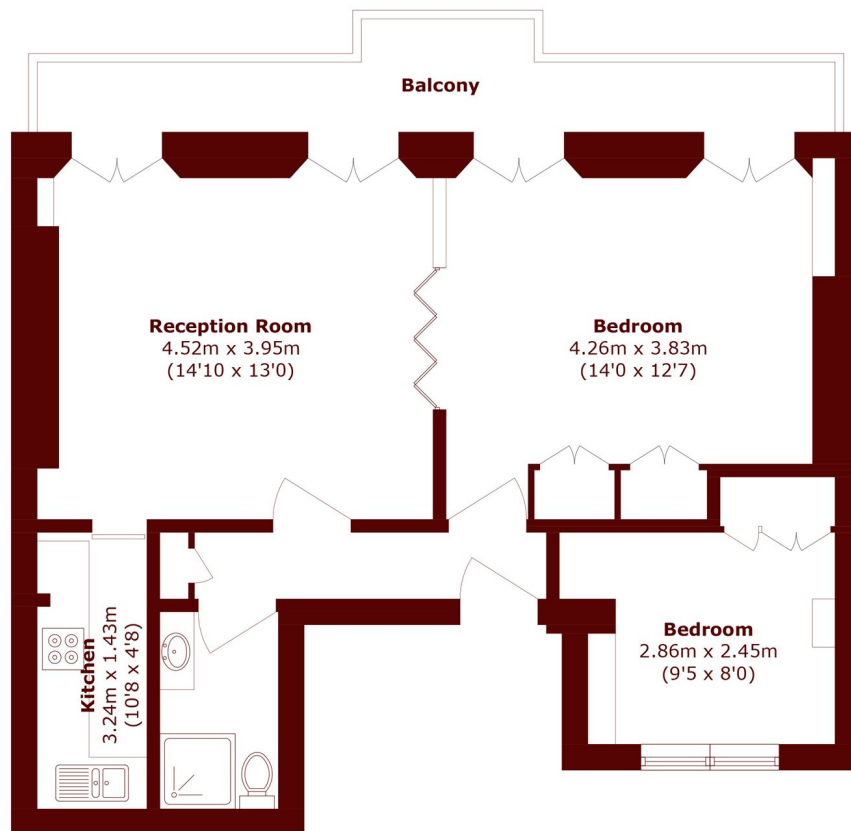

First Floor

Total area (approx.): 58.7 sq. m (631.8 sq. ft)

Balcony area (approx.): 8.5 sq. m (91.5 sq. ft)

Chelsea
020 7591 5580

Energy Rating: We aim to make our particulars both accurate and reliable. However, they are not guaranteed; nor do they form part of an offer or contract. If you require clarification on any points then please contact us, especially if you're traveling some distance to view. Please note that appliances and heating systems have not been tested and therefore no warranties can be given as to their good working order

MARSH &
PARSONS