



WOOLWICH ROAD, SE10

£400,000

Top floor apartment
Two bedrooms
Winter garden
Off-street parking
Views of Canary Wharf
Energy rating: b

@marshandparsons
marshandparsons.co.uk

MARSH &
PARSONS



ABOUT THE PROPERTY

Top floor modern apartment which features views of Canary Wharf, a very useful winter garden and an allocated off-street parking space. The interior briefly comprises a very spacious living room with dining space, an open plan kitchen, two large bedrooms and a recently fitted and impressive bathroom suite. Moreover, the property stands out from its immaculate interior, wood flooring and large double glazed windows allowing for floods of natural light.

Greenwich Pleasaunce is just moments away. Maze Hill mainline station and Greenwich's royal park are a short walking distance away with the town centre and O2 close by.



STEP INSIDE WOOLWICH ROAD

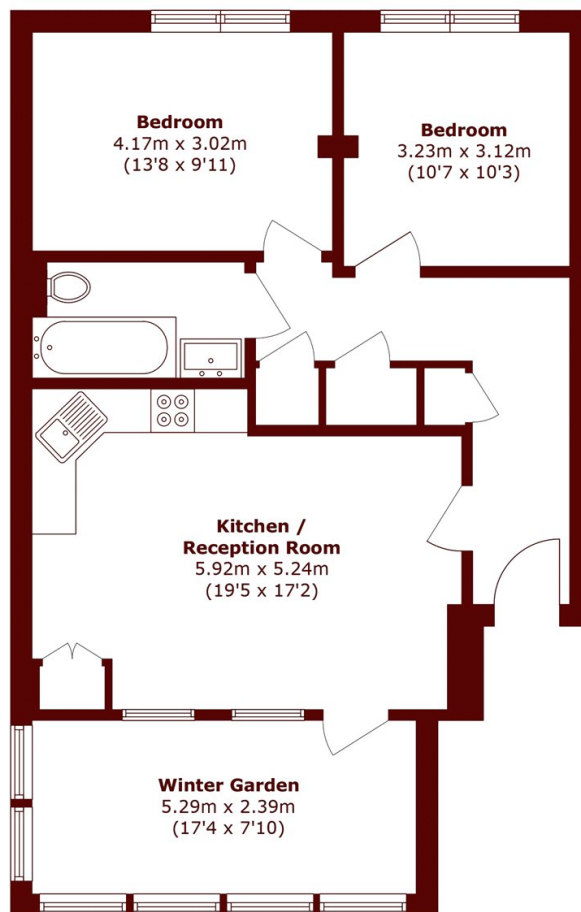

Third Floor

Total area (approx.): 80.4 sq. m (865.4 sq. ft)

Greenwich
020 8312 8312

Energy Rating: B We aim to make our particulars both accurate and reliable. However, they are not guaranteed; nor do they form part of an offer or contract. If you require clarification on any points then please contact us, especially if you're traveling some distance to view. Please note that appliances and heating systems have not been tested and therefore no warranties can be given as to their good working order

MARSH &
PARSONS