



GLOUCESTER AVENUE, NW1

£725,000

One bedroom
Shower room
Private garden
No onward chain
Central Primrose Hill
Large reception rooms

@marshandparsons
marshandparsons.co.uk

MARSH &
PARSONS



ABOUT THE PROPERTY

A beautifully presented one-bedroom period conversion situated in the heart of the ever-popular Primrose Hill. The property features two well-proportioned reception rooms and benefits from a private garden. Offered with no onward chain, it presents an excellent opportunity in this highly sought-after location.

Primrose Hill is one of London's most sought-after neighbourhoods, known for its charming village atmosphere, elegant period homes, and vibrant independent cafés and boutiques. Located adjacent to Regent's Park, it offers a peaceful residential setting with stunning panoramic views of the London skyline and excellent access to Central London.



STEP INSIDE GLOUCESTER AVENUE

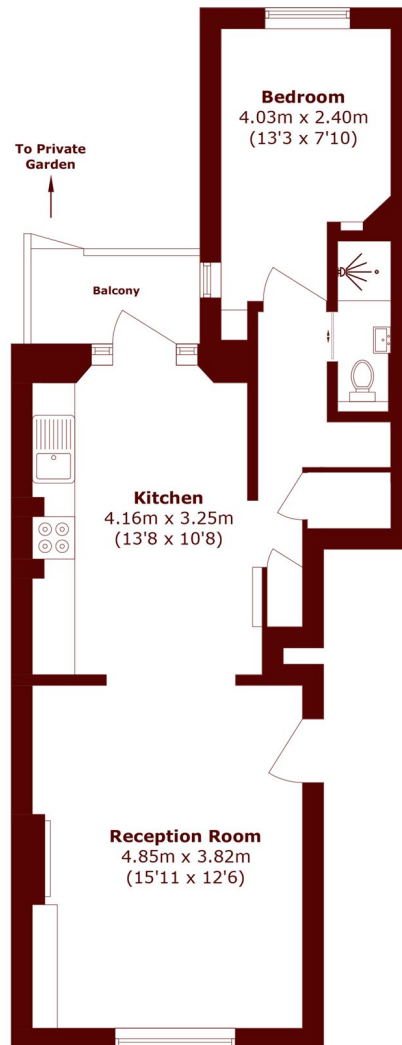

Total area (approx.): 48.6 sq. m (523.1 sq. ft)

Balcony area (approx.): 2.9 sq. m (31.2 sq. ft)

Camden
020 7244 2200

Energy Rating: D We aim to make our particulars both accurate and reliable. However, they are not guaranteed; nor do they form part of an offer or contract. If you require clarification on any points then please contact us, especially if you're traveling some distance to view. Please note that appliances and heating systems have not been tested and therefore no warranties can be given as to their good working order

MARSH &
PARSONS