



LEIGHAM COURT ROAD, SW16

£499,950

Share of freehold
Three bedrooms
Modern renovation
Balcony
900 sqft
EPC Rating: D

@marshandparsons
marshandparsons.co.uk

MARSH &
PARSONS

ABOUT THE PROPERTY

This recently renovated flat boasts three large bedrooms, a private balcony and separate kitchen and living room. There is also access to the buildings shared gardens, with further benefits of off street parking and share of freehold tenure. This property is perfect for first time buyers looking for a flat in the heart of Streatham.

Leigham Court Road is situated close to both Streatham and Tulse Hill stations, as well as all the amenities of Streatham High Road. Streatham Hill station provides commuters with excellent services into Clapham Junction, Balham, London Bridge and Victoria.









STEP INSIDE LEIGHAM COURT ROAD

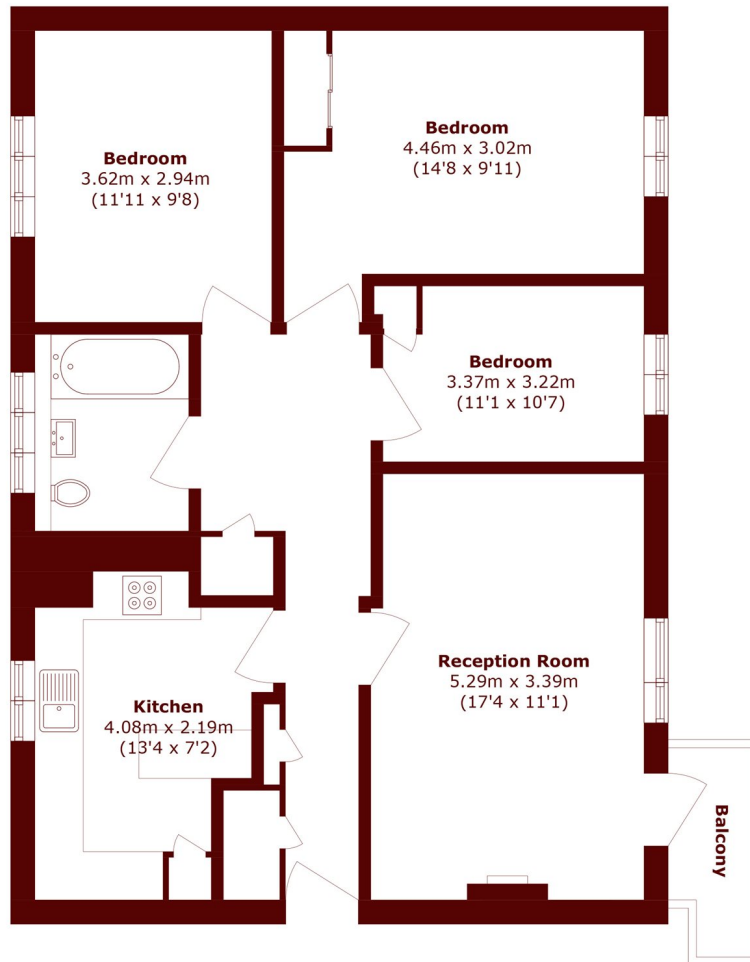

First Floor

Total area (approx.): 81.6 sq. m (878.3 sq. ft)

Balcony area (approx.): 2.5 sq. m (26.9 sq. ft)

Streatham
020 8671 0171

Energy Rating: D We aim to make our particulars both accurate and reliable. However, they are not guaranteed; nor do they form part of an offer or contract. If you require clarification on any points then please contact us, especially if you're traveling some distance to view. Please note that appliances and heating systems have not been tested and therefore no warranties can be given as to their good working order

MARSH &
PARSONS