



LANSDOWNE CRESCENT, W11

£750,000

Second Floor Flat
South-Facing
Prime Location
One Double Bedroom
Communal Garden Access
Natural Light

@marshandparsons
marshandparsons.co.uk

MARSH &
PARSONS

ABOUT THE PROPERTY

A well-proportioned and fabulously located apartment situated on the second floor of a beautifully maintained period conversion.

Lansdowne Crescent is ideally located for the shops, restaurants, cafés and bars of both Holland Park and Notting Hill. Good transport links are close by at Holland Park Underground for the Central line and Notting Hill Gate Underground for the Central, Circle and District lines.







FURTHER DETAILS

The property occupies an elevated position, offering beautiful views of Saint John's Church and beyond to Holland Park and Notting Hill. It also benefits from access to Lansdowne Crescent Gardens and Ladbrooke Square Gardens, via subscription. The apartment comprises a reception room, separate kitchen, spacious double bedroom benefiting from built-in storage and a well-appointed bathroom.



STEP INSIDE LANSDOWNE CRESCENT

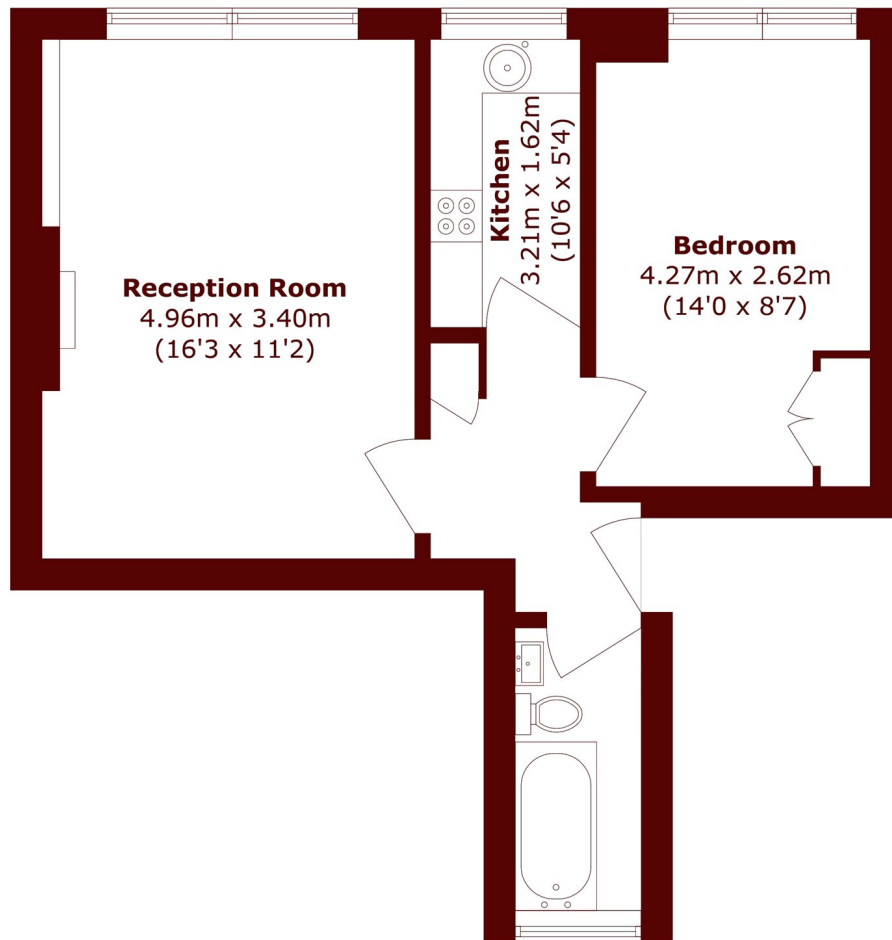

Second Floor

Total area (approx.): 41.7 sq. m (448.8 sq. ft)

Holland Park
020 7605 6890

Energy Rating: We aim to make our particulars both accurate and reliable. However, they are not guaranteed; nor do they form part of an offer or contract. If you require clarification on any points then please contact us, especially if you're traveling some distance to view. Please note that appliances and heating systems have not been tested and therefore no warranties can be given as to their good working order

MARSH &
PARSONS