



VICTORIA WAY, SE7

£400,000

Conversion flat
Three bedrooms
Two bathrooms
Shared garden
Chain free
Energy rating: c

@marshandparsons
marshandparsons.co.uk

MARSH &
PARSONS



ABOUT THE PROPERTY

Beautifully presented three bedroom Victorian conversion flat, modernised to a high specification. Offers a bright open plan kitchen/living area with integrated appliances, principal bedroom with en suite, two further bedrooms, and a modern family bathroom. Additional benefits include a long lease, no onward chain, secure bike and bin storage, and access to a communal garden, blending period charm with modern living.

A short walk from Charlton station with direct links to London Bridge, plus bus routes to North Greenwich and Woolwich Arsenal. Charlton Retail Park is nearby, offering shops, supermarkets, restaurants, and leisure facilities.



STEP INSIDE VICTORIA WAY

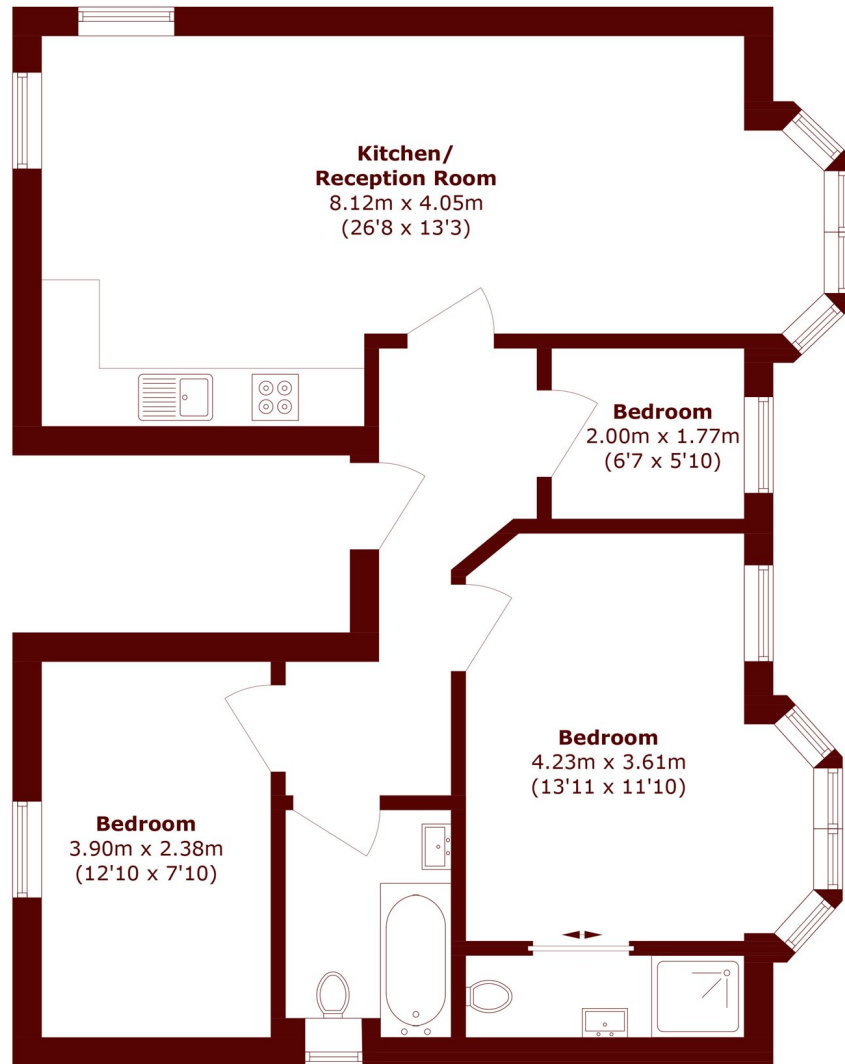

Total area (approx.): 70.1 sq. m (754.6 sq. ft)

Charlton
020 8378 5450

Energy Rating: C We aim to make our particulars both accurate and reliable. However, they are not guaranteed; nor do they form part of an offer or contract. If you require clarification on any points then please contact us, especially if you're traveling some distance to view. Please note that appliances and heating systems have not been tested and therefore no warranties can be given as to their good working order

**MARSH &
PARSONS**