



ST. GEORGES SQUARE, SW1V

£530 per week

This charming property features a bright and spacious reception room with large windows that flood the space with natural light, ideal for both relaxing and entertaining.

Large Double Bedroom
St Georges Square
Excellent condition

High ceilings
Abundance of natural light
Energy rating: d

STEP INSIDE ST. GEORGES SQUARE

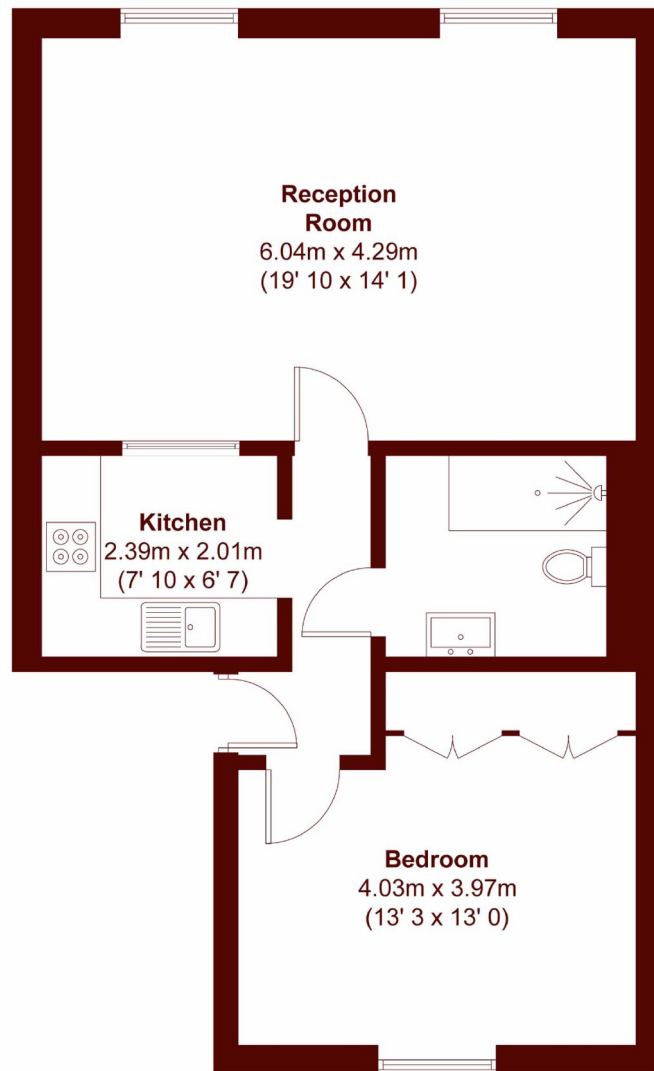

APPROX. GROSS INTERNAL FLOOR AREA
589 SQFT / 54.7 SQM

Pimlico & Westminster
020 7828 8100

Energy Rating: D We aim to make our particulars both accurate and reliable. However, they are not guaranteed; nor do they form part of an offer or contract. If you require clarification on any points then please contact us, especially if you're traveling some distance to view. Please note that appliances and heating systems have not been tested and therefore no warranties can be given as to their good working order

**MARSH &
PARSONS**