



ROEHAMPTON COURT, SW13

£575,000

Two double bedrooms
Panoramic views of Barnes Common
Secure off-street parking
Private garage
Spacious living
Close to Barnes Station

@marshandparsons
marshandparsons.co.uk

MARSH &
PARSONS



ABOUT THE PROPERTY

Marsh & Parsons are delighted to present this impressive two-bedroom apartment opposite Barnes Common, offering an abundance of natural light and spectacular views across Barnes Common and the London skyline. The flat comprises two bedrooms, both with fitted storage, a family bathroom, and a generous reception room opening onto a large private balcony. The property further benefits from a separate dining room and a spacious kitchen. It benefits include off-street parking, a garage and incredible views overlooking the Common, providing a wonderful sense of space and greenery.



STEP INSIDE ROEHAMPTON COURT

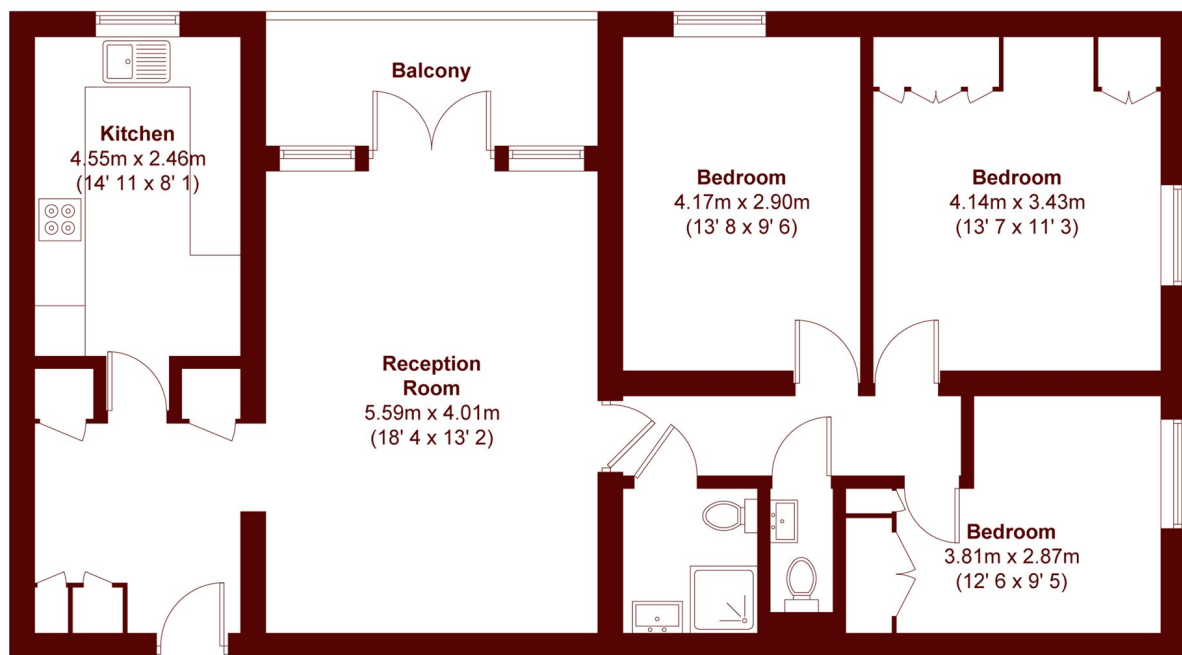

APPROX. GROSS INTERNAL FLOOR AREA = 88.4 SQM / 952 SQFT
APPROX. GROSS EXTERNAL BALCONY AREA = 6.2 SQM / 67 SQFT

Barnes & East Sheen
020 8563 8333

Energy Rating: C We aim to make our particulars both accurate and reliable. However, they are not guaranteed; nor do they form part of an offer or contract. If you require clarification on any points then please contact us, especially if you're traveling some distance to view. Please note that appliances and heating systems have not been tested and therefore no warranties can be given as to their good working order

**MARSH &
PARSONS**