



Durham Terrace, W2

£835 per week (£3,575 pcm)



- One Bedroom
- Natural Light
- Wooden Flooring
- High Ceilings
- Period Building
- Tree Lined Street

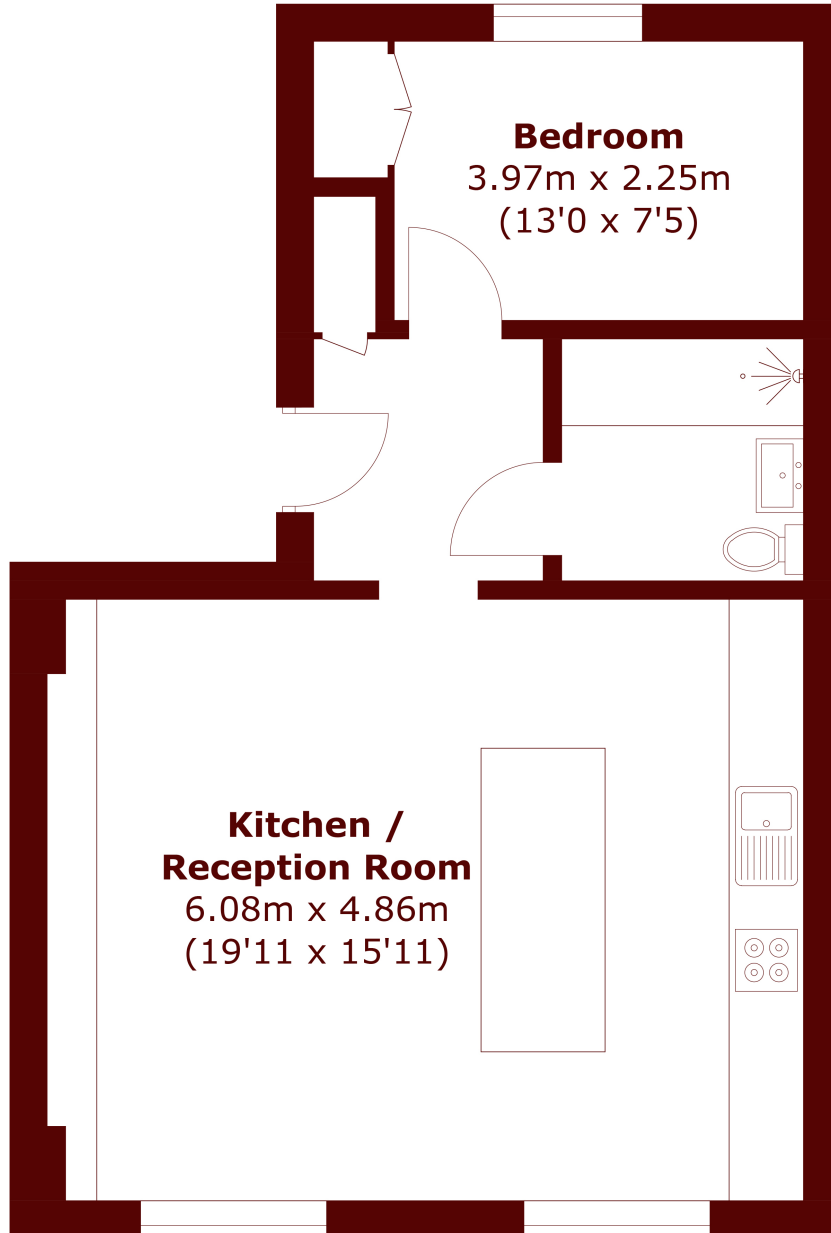

Total area (approx.): 47.5 sq. m (511.3 sq. ft)

Marsh & Parsons Notting Hill

2-6 Kensington Park Road,
London, W11 3BU
020 7313 2890