



## CHURTON PLACE, W4

£525,000

Two bedrooms  
Recently refurbished  
Top floor apartment  
Gated parking  
Long lease  
Energy rating: d

@marshandparsons  
marshandparsons.co.uk

MARSH &  
PARSONS



# ABOUT THE PROPERTY

This stylish top-floor apartment has been renovated to a high standard. Featuring brand-new windows and elegant herringbone wood flooring, the home combines modern comfort with timeless design.

Churton Place is located in Chiswick village which is 0.2 mile away from strand on the green and the river thames. Close by is Chiswick High Road where there is an array of cafes, Restaurants, Bars and Boutique shops. Transport links include Kew Bridge station (Overground) and Gunnersbury station (District Line).



# STEP INSIDE CHURTON PLACE

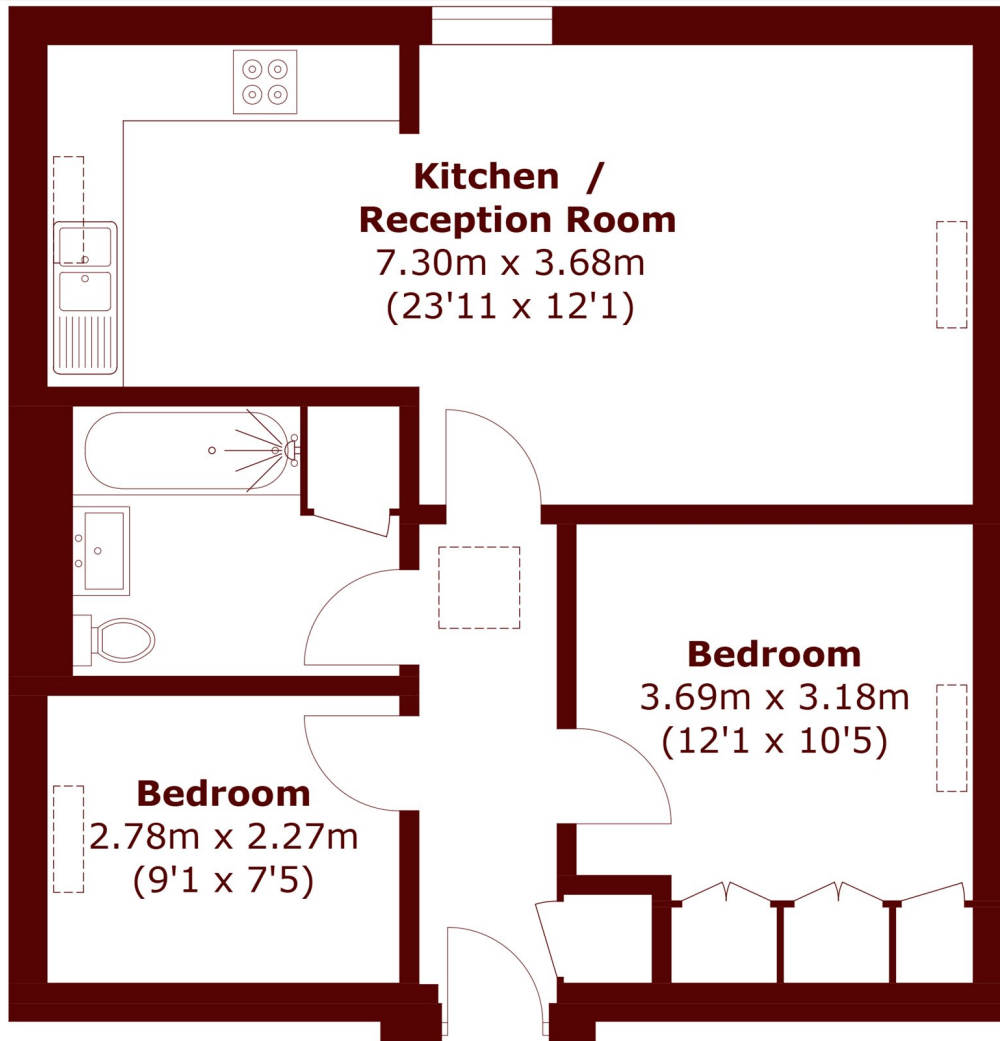

## Second Floor

Total area (approx.): 54.3 sq. m (584.5 sq. ft)

Chiswick  
020 8994 2556

Energy Rating: D We aim to make our particulars both accurate and reliable. However, they are not guaranteed; nor do they form part of an offer or contract. If you require clarification on any points then please contact us, especially if you're traveling some distance to view. Please note that appliances and heating systems have not been tested and therefore no warranties can be given as to their good working order

MARSH &  
PARSONS