



ST. BENEDICTS CLOSE, SW17

£275,000

One double bedroom
First floor flat
Open plan kitchen reception
On-site allocated parking
Communal grounds
EPC: C

@marshandparsons
marshandparsons.co.uk

MARSH &
PARSONS



ABOUT THE PROPERTY

Offers in excess of A first floor one double bedroom flat located in a residential setting with communal green space.

Located in a private residential estate in Tooting, this property is well situated for easy access to an array of shops, bars and restaurants on offer. The wide open spaces of Tooting Bec Common are also close by, as are the excellent transport links including Tooting Bec and Broadway Underground and Tooting Station.



STEP INSIDE ST. BENEDICTS CLOSE

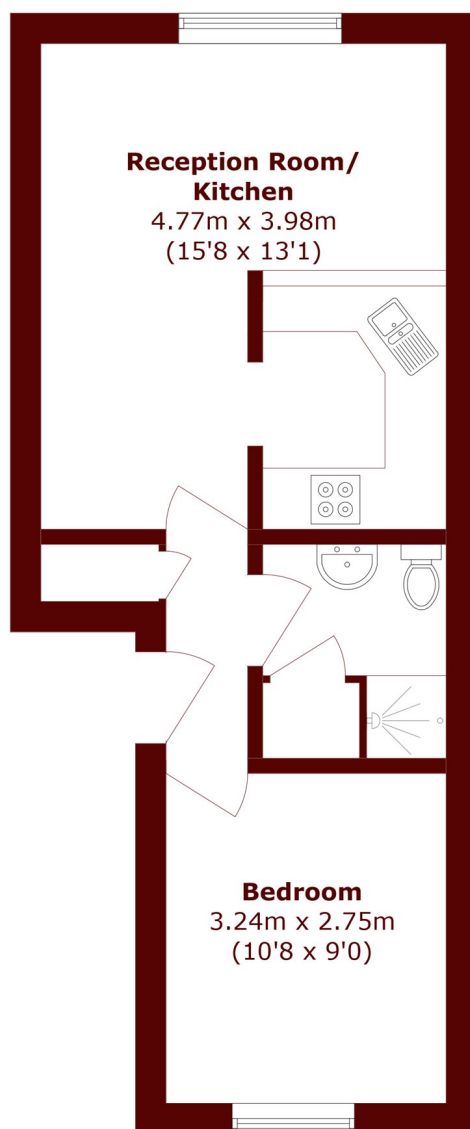

Total area (approx.): 35.3 sq. m (379.9 sq. ft)

Tooting
020 8767 3655

Energy Rating: C We aim to make our particulars both accurate and reliable. However, they are not guaranteed; nor do they form part of an offer or contract. If you require clarification on any points then please contact us, especially if you're traveling some distance to view. Please note that appliances and heating systems have not been tested and therefore no warranties can be given as to their good working order

**MARSH &
PARSONS**