



## DORSET HOUSE, NW1

£925,000

Two double bedroom  
Long lease  
Upper floor with lift  
24 hr porter  
Central location  
Private terrace

@marshandparsons  
marshandparsons.co.uk

MARSH &  
PARSONS



# ABOUT THE PROPERTY

A beautifully presented top-floor two-bedroom flat with a private east- and south-facing terrace offering excellent natural light throughout the day. Finished to a high standard with double glazing throughout, the property is sold with a curated selection of premium designer furnishings, including a bespoke Binova kitchen, Tisettanta bookcase, Bodema sofa, and Artemide lighting. The principal bedroom features a Lema fitted wardrobe, while the guest bedroom includes an Erba wardrobe and Alf chest of drawers. Stylishly designed with exceptional outdoor space, this turnkey apartment offers elegant contemporary living.



# STEP INSIDE DORSET HOUSE

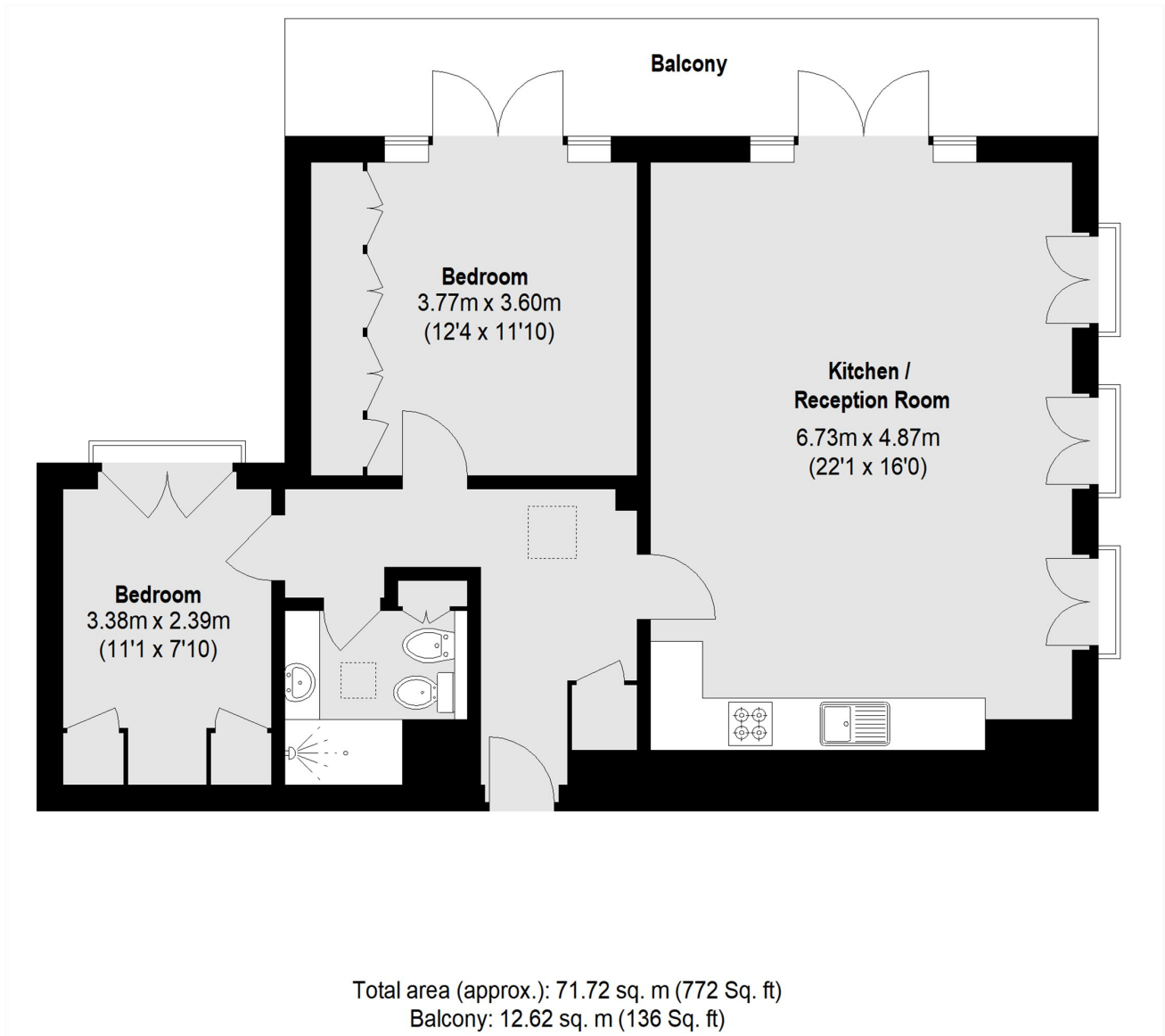

**Marylebone & Mayfair**  
020 7935 1775

Energy Rating: E We aim to make our particulars both accurate and reliable. However, they are not guaranteed; nor do they form part of an offer or contract. If you require clarification on any points then please contact us, especially if you're traveling some distance to view. Please note that appliances and heating systems have not been tested and therefore no warranties can be given as to their good working order

**MARSH &  
PARSONS**