



## BOLLO LANE, W4

£320,000

Spacious one-bedroom  
Pocket living scheme  
New build development  
Amazing views  
Communal roof terrace  
Energy rating: b

@marshandparsons  
marshandparsons.co.uk

MARSH &  
PARSONS



# ABOUT THE PROPERTY

A spacious one-bedroom apartment within a new build development on Bollo Lane, Chiswick. The property offers amazing views, a roof terrace, and a modern specification throughout. This unique home is available through the Pocket Living scheme, created to help Londoners step onto the property ladder.

Perfectly located on Bollo Lane, the property is just a short stroll from Chiswick Park Underground Station (District Line) and South Acton Overground Station, offering fast connections across London. Residents will also enjoy Chiswick's vibrant high street, local cafés, and expansive green spaces all within easy reach.



# STEP INSIDE BOLLO LANE

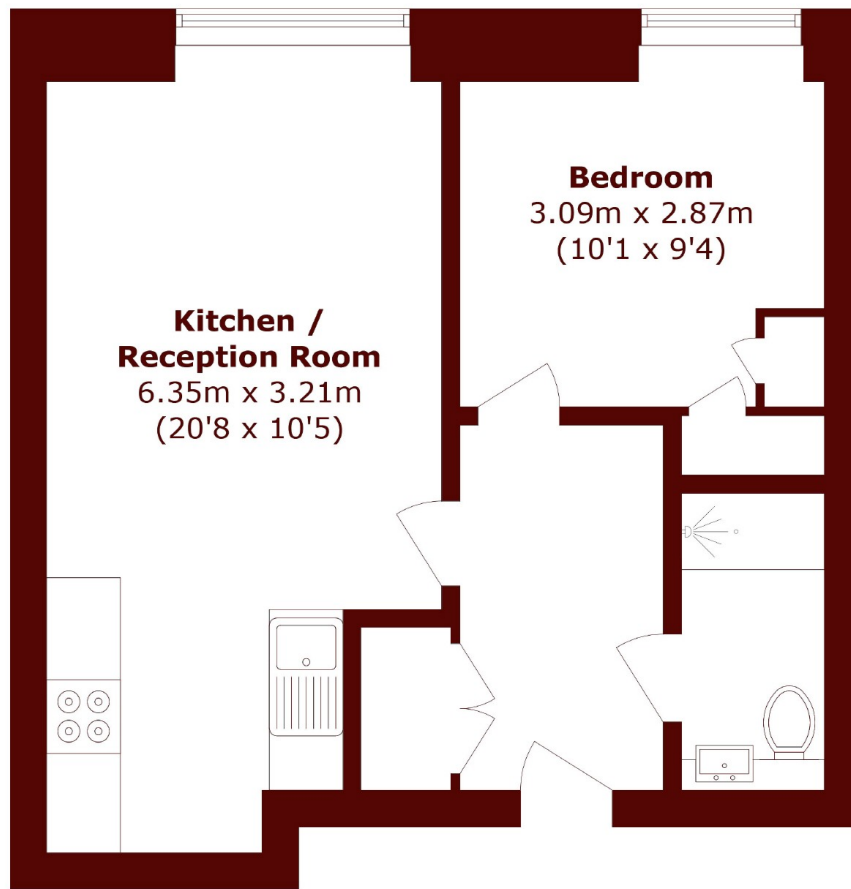

Total area (approx.): 39.2 sq. m (422.0 sq. ft)

Chiswick  
020 8994 2556

Energy Rating: B We aim to make our particulars both accurate and reliable. However, they are not guaranteed; nor do they form part of an offer or contract. If you require clarification on any points then please contact us, especially if you're traveling some distance to view. Please note that appliances and heating systems have not been tested and therefore no warranties can be given as to their good working order

MARSH &  
PARSONS