



## Camden Road, NW1

£350,000

 1  1  1  TBC

- No Onward Chain
- Share of Freehold

- One Bedroom
- Fitted Kitchen

- Lift Assisted
- Close to Camden Market

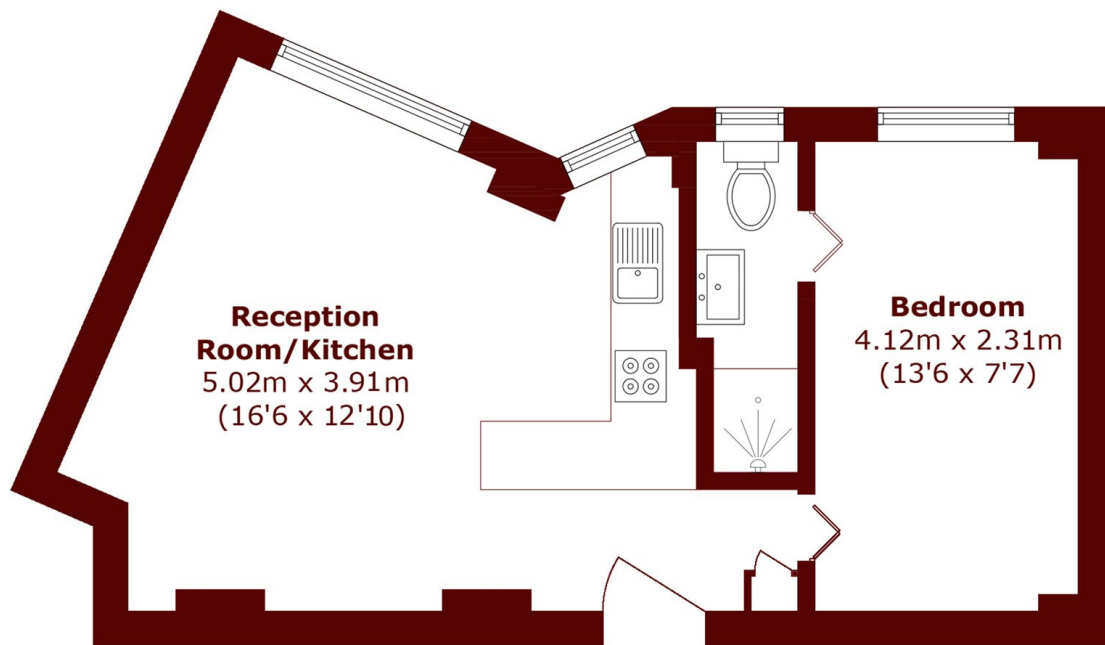

Total area (approx.): 34.6 sq. m (372.4 sq. ft)

**Marsh & Parsons Camden**

27 Parkway, London, NW1  
7PN  
020 7244 2200