



## GLOUCESTER TERRACE, W2

£875,000

Two double bedrooms  
Underground parking  
En suite bathroom  
Share of freehold  
Porter & lift  
EPC- C

@marshandparsons  
marshandparsons.co.uk

MARSH &  
PARSONS



# ABOUT THE PROPERTY

This fantastic, bright and well proportioned 2 bedroom apartment is set on the 4th floor of a residential building with a lift and portorage and benefits from neutral decor throughout.

Gloucester Terrace is well located for the restaurants, shops and bars in Westbourne Grove & Queensway. For the motorist easy access is provided to the A40 (M) for routes in and out of London. Bayswater is the closest Station.



# STEP INSIDE GLOUCESTER TERRACE

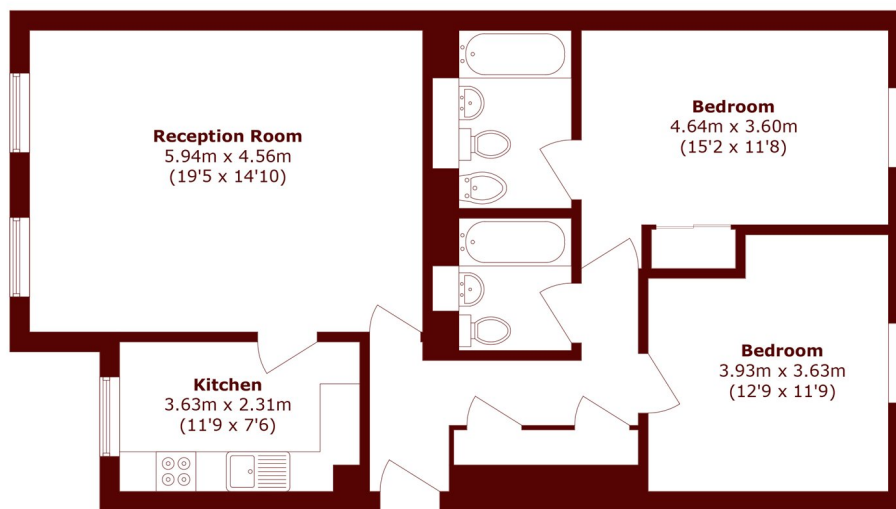

Total area (approx.): 87.1 sq. m (937.5 sq. ft)

Notting Hill  
020 7313 2890

Energy Rating: C We aim to make our particulars both accurate and reliable. However, they are not guaranteed; nor do they form part of an offer or contract. If you require clarification on any points then please contact us, especially if you're traveling some distance to view. Please note that appliances and heating systems have not been tested and therefore no warranties can be given as to their good working order

MARSH &  
PARSONS