



## LINDEN GARDENS, W4

£2,600 per month

One bedroom  
Modern interior  
Large reception  
Built in storage  
Private garden  
Energy rating: d

@marshandparsons  
marshandparsons.co.uk

MARSH &  
PARSONS



# ABOUT THE PROPERTY

This stylish and contemporary one bedroom property boasting a large reception room, separate modern fitted kitchen, double bedroom with ample storage and access to a private garden.

Linden Gardens offers immediate access to the boutique cafés, restaurants and amenities of Chiswick High Road, while both Turnham Green and Chiswick Park Underground stations are within easy walking distance, offering swift connections into Central London.



# STEP INSIDE LINDEN GARDENS

## LINDEN GARDENS

Approximate Gross Internal Area  
612 sq. ft. (56.88 sq. m.)

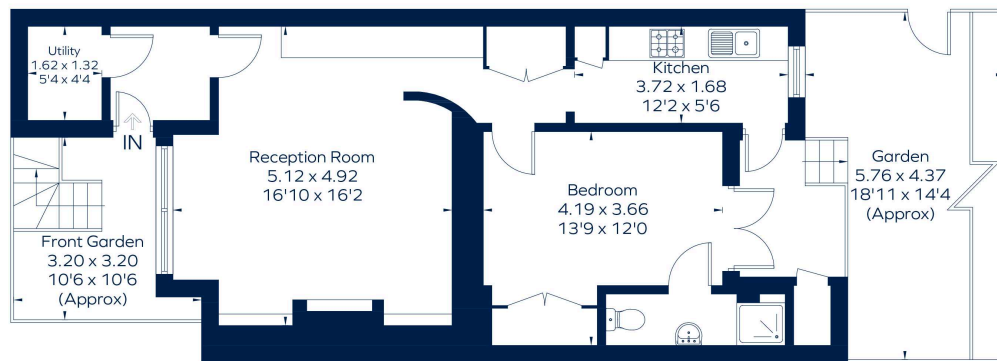

Garden Flat

Drawn for illustration and identification purposes only.  
ID 815634

Chiswick  
020 8629 0900

Energy Rating: D We aim to make our particulars both accurate and reliable. However, they are not guaranteed; nor do they form part of an offer or contract. If you require clarification on any points then please contact us, especially if you're traveling some distance to view. Please note that appliances and heating systems have not been tested and therefore no warranties can be given as to their good working order

MARSH &  
PARSONS