



## PARK VISTA, SE10

£460,000

One bed apartment  
Second floor  
Share of freehold  
Allocated off-street parking  
Overlooking Greenwich park  
Energy rating: c

@marshandparsons  
marshandparsons.co.uk

MARSH &  
PARSONS



# ABOUT THE PROPERTY

Bright and spacious second floor apartment overlooking Greenwich's royal park. The property comes with a share of freehold, allocated off-street parking, within a gated car park and is being sold chain free. Inside you will find a spacious living room, an open plan kitchen, a large bedroom and a modern bathroom suite. Further advantages include recently fitted double glazed windows, entry phone system and an external storage unit.

Greenwich park is moments away on foot and just a short walk away are some beautiful riverside pubs and restaurants, Maze Hill rail station and Greenwich town centre, for Cutty Sark DLR station.



# STEP INSIDE PARK VISTA

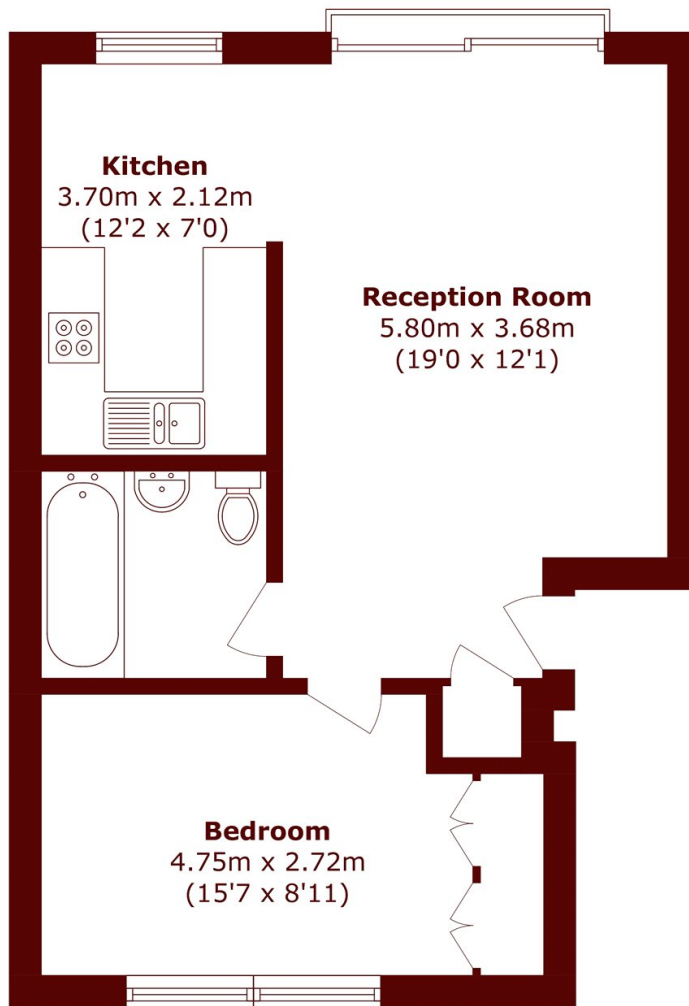

Total area (approx.): 46.2 sq. m (497.2 sq. ft)

Greenwich  
020 8312 8312

Energy Rating: C We aim to make our particulars both accurate and reliable. However, they are not guaranteed; nor do they form part of an offer or contract. If you require clarification on any points then please contact us, especially if you're traveling some distance to view. Please note that appliances and heating systems have not been tested and therefore no warranties can be given as to their good working order

MARSH &  
PARSONS