



## FOULSER ROAD, SW17

£975,000

Four Bedrooms  
Two Bathrooms  
Downstairs WC  
Private Rear Garden  
Short Walk To Tooting Bec Tube  
Station

@marshandparsons  
marshandparsons.co.uk

MARSH &  
PARSONS

# ABOUT THE PROPERTY

A well presented four bedroom modern family home situated on one of the most sought after Roads in Tooting Bec.

This property offers 1227 sqft of accommodation across three floors. The ground floor boasts an open plan kitchen and living room, a larger than average private garden, and a WC. The first floor hosts two double bedrooms, a smaller third bedroom and a family bathroom. A further double bedroom with a en suite can be found on the second floor.

Foulser Road is a quiet residential road in the heart of Tooting Bec. Local amenities, bars and restaurants are in









# STEP INSIDE FOULSER ROAD

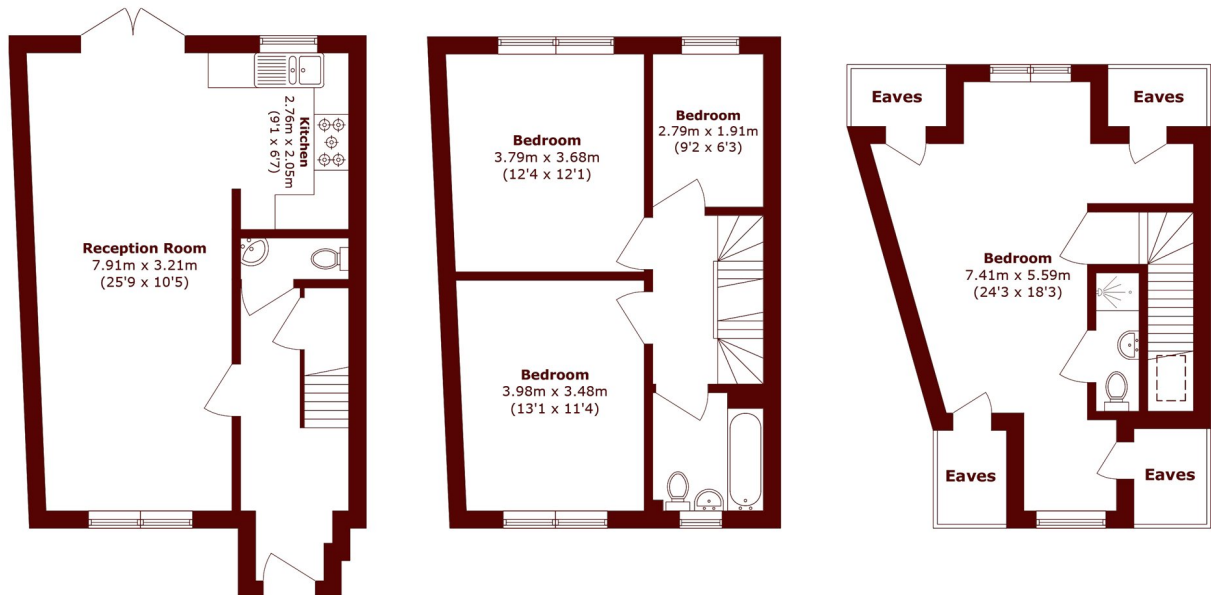

Total area (approx.): 114.0 sq. m (1227.1 sq. ft)  
(Excluding Eaves)

**Tooting**  
020 8767 3655

Energy Rating: C We aim to make our particulars both accurate and reliable. However, they are not guaranteed; nor do they form part of an offer or contract. If you require clarification on any points then please contact us, especially if you're traveling some distance to view. Please note that appliances and heating systems have not been tested and therefore no warranties can be given as to their good working order

**MARSH &  
PARSONS**