



LEIGHAM COURT ROAD, SW16

£625,000

Three bedrooms
Private outside space
Great condition
Streatham hill
Circa 1,000sqft
EPC: E

@marshandparsons
marshandparsons.co.uk

MARSH &
PARSONS

ABOUT THE PROPERTY

An immaculately presented three double bedroom property located on a popular residential street close to Streatham Hill Station and local amenities. The property is finished to a fine standard throughout, offering a well landscaped garden and living space.

Leigham Court Road is a popular road sitting peacefully just off Streatham High Road which meets Streatham Common at the other end, well placed for the wide variety of shops, bars and restaurants of Streatham High Street and just 0.2m from Streatham Hill Station which connects to London Victoria.









STEP INSIDE LEIGHAM COURT ROAD

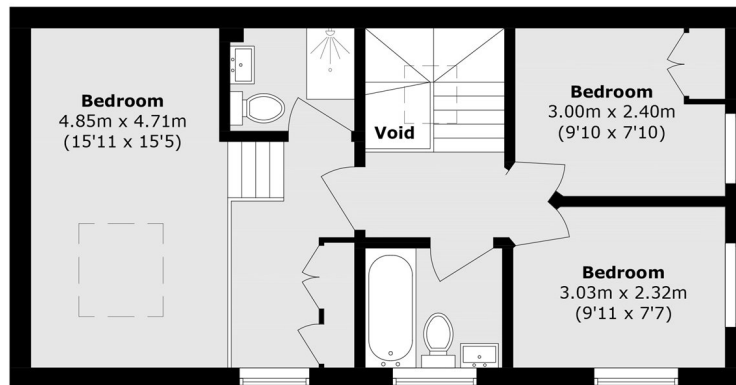

First Floor

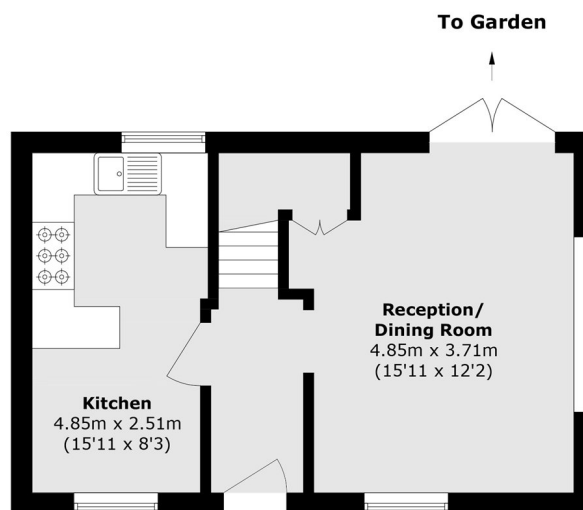

Ground Floor

Total area (approx.): 84.7 sq. m (911.7 sq. ft)
(Excluding Void)

Streatham
020 8671 0171

Energy Rating: E We aim to make our particulars both accurate and reliable. However, they are not guaranteed; nor do they form part of an offer or contract. If you require clarification on any points then please contact us, especially if you're traveling some distance to view. Please note that appliances and heating systems have not been tested and therefore no warranties can be given as to their good working order

**MARSH &
PARSONS**