



MONTAGU MANSIONS, W1U

£2,000,000

Two double bedrooms

Two bathrooms

Long lease

Porter

Mansion block

Prime location

@marshandparsons
marshandparsons.co.uk

MARSH &
PARSONS



ABOUT THE PROPERTY

This spacious apartment finished to a high specification throughout with high ceilings and masses of natural light. Situated on the second floor (with lift), this apartment comprises a large entrance hall leading to the spacious reception room with feature fire place, and a Juliette Balcony. There is a modern kitchen with built in appliances, two large double bedrooms with plenty of storage and a contemporary tiled bathroom and WC. The building further benefits from an on site porter.

Montagu Mansions is a highly sought after mansion block occupying its own quiet street just behind Baker Street. It is ideally located for the supermarkets and cafes on Crawford Street and Baker Street.



STEP INSIDE MONTAGU MANSIONS

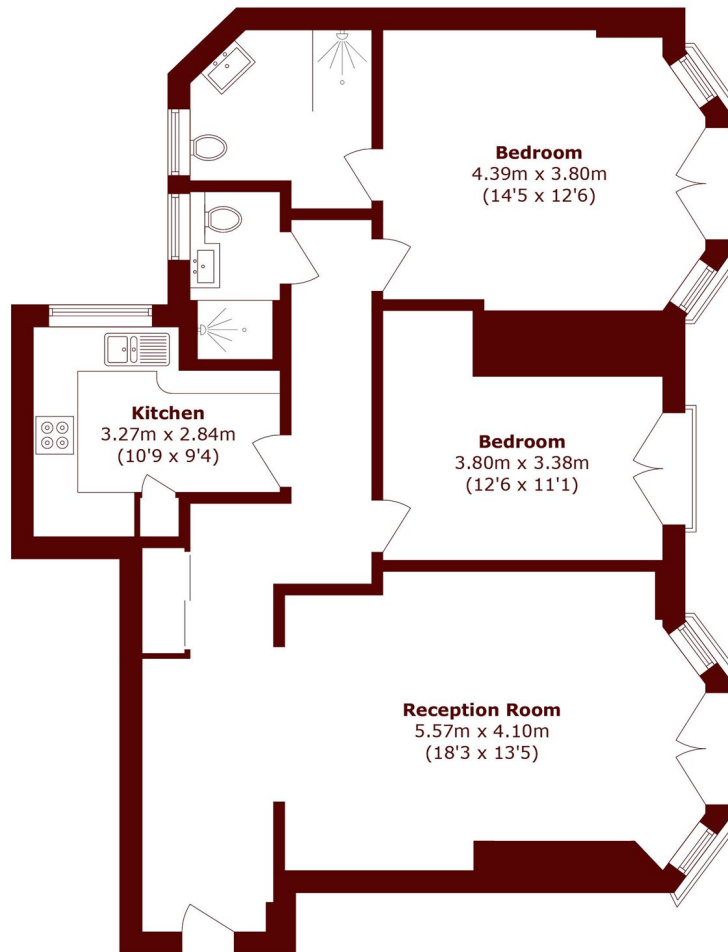

Second Floor

Total area (approx.): 85.9 sq. m (924.6 sq. ft)

Marylebone & Mayfair
020 7935 1775

Energy Rating: C We aim to make our particulars both accurate and reliable. However, they are not guaranteed; nor do they form part of an offer or contract. If you require clarification on any points then please contact us, especially if you're traveling some distance to view. Please note that appliances and heating systems have not been tested and therefore no warranties can be given as to their good working order

MARSH &
PARSONS