



## BRAMHOPE LANE, SE7

£675,000

Terraced house  
Three bedrooms  
Two bathrooms  
Garden  
Private parking  
Energy rating: c

@marshandparsons  
marshandparsons.co.uk

MARSH &  
PARSONS



# ABOUT THE PROPERTY

This well-presented three bedroom freehold house offers private parking and a rear garden with decking. The ground floor features a modern kitchen, open plan living/dining area with garden access, and a WC. Upstairs are two bedrooms, a refurbished family bathroom, and built-in storage, while the top floor hosts the principal bedroom with a walk-in closet, refurbished en suite, and London skyline views.

Ideally located near Charlton station with direct links to central London, the property is close to shops, cafés, Charlton Park, and within easy reach of Greenwich, Blackheath, and the Peninsula. It also offers access to highly regarded schools.



# STEP INSIDE BRAMHOPE LANE

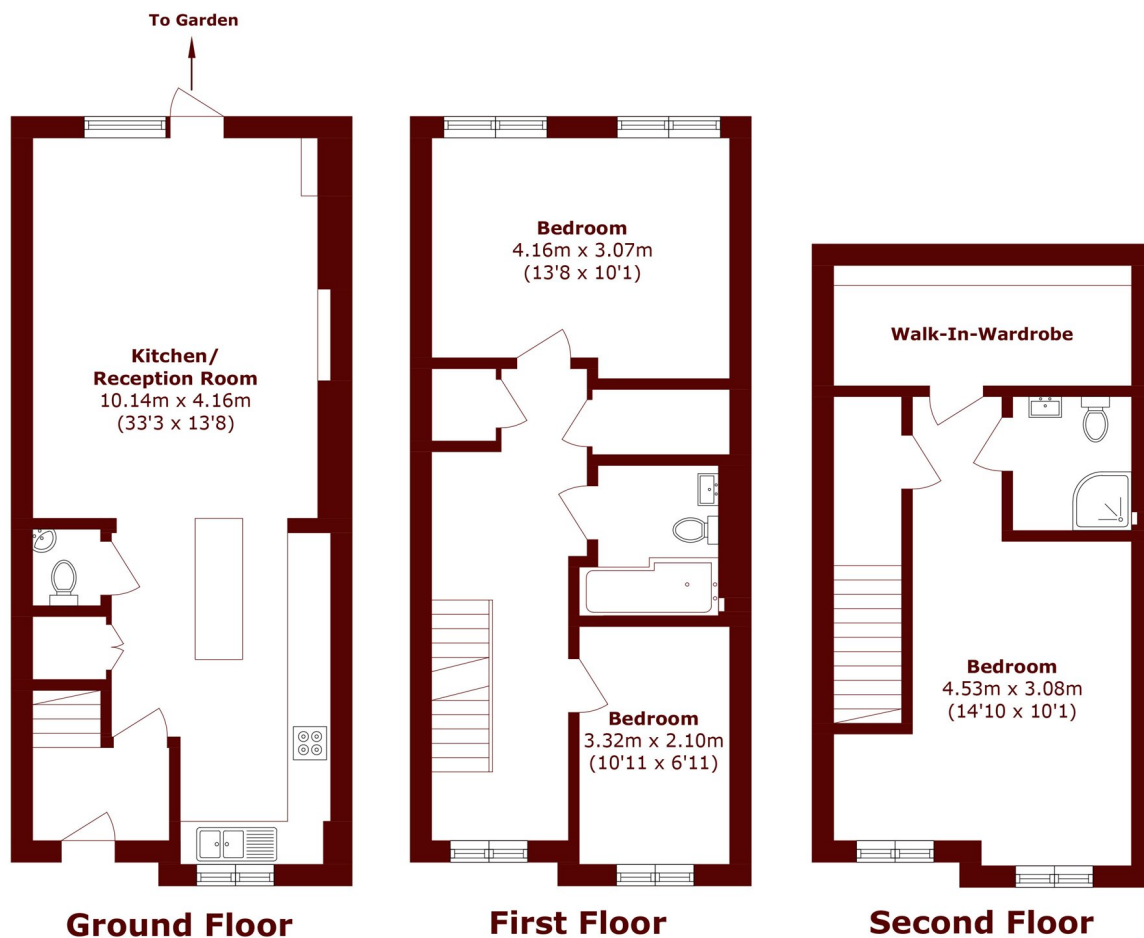

Total area (approx.): 117.1 sq. m (1260.4 sq. ft)

**Charlton**  
020 8293 0454

Energy Rating: We aim to make our particulars both accurate and reliable. However, they are not guaranteed; nor do they form part of an offer or contract. If you require clarification on any points then please contact us, especially if you're traveling some distance to view. Please note that appliances and heating systems have not been tested and therefore no warranties can be given as to their good working order

**MARSH &  
PARSONS**