



## MONMOUTH ROAD, W2

£2,817 per month

A stunning one bedroom apartment presented in excellent condition throughout.

One bedroom  
Wooden floors  
Amazing location

Generous living room  
Abundance of natural light  
EPC - D

# STEP INSIDE MONMOUTH ROAD

Monmouth Road, W2

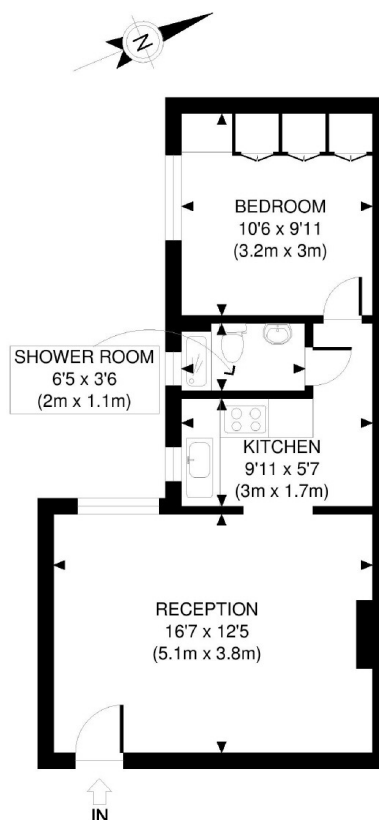

RAISED GROUND FLOOR  
GROSS INTERNAL  
FLOOR AREA 413 SQ FT

APPROX. GROSS INTERNAL FLOOR AREA 413 SQ FT / 38 SQM

Ref:

Copyright



Disclaimer: Floor plan measurements are approximate and are for illustrative purposes only. While we do not doubt the floor plan accuracy and completeness, you or your advisors should conduct a careful, independent investigation of the property in respect of monetary valuation

Notting Hill  
020 7313 6910

Energy Rating: D We aim to make our particulars both accurate and reliable. However, they are not guaranteed; nor do they form part of an offer or contract. If you require clarification on any points then please contact us, especially if you're traveling some distance to view. Please note that appliances and heating systems have not been tested and therefore no warranties can be given as to their good working order

MARSH &  
PARSONS